

ONE & SIX YEAR STREET IMPROVEMENT PLAN

CITY OF LEXINGTON

Planning Period from 2015 to 2020

Project No. 127-A1-001

ONE YEAR PLAN			Estimated Project Cost
Program No.	Project and Description		Estimated Project Cost
1.	(95) Ontario Street Paving Improvements <i>Paving improvements on Ontario Street from 9th to 10th Street</i>		\$45,000
2.	(114) Taylor Street Storm Sewer Improvements <i>Storm Sewer Improvements form US Hwy #30 to Taylor Street and one block to the east on 8th Street</i>		\$258,000
3.	(121) Street Paving in CED Addition and Storm Sewer Improvements <i>Phase II Improvements within CED Addition</i>		\$450,000
4.	(123) Grant Street Improvements from 7th to 8th Street <i>Improve site distance @ intersections and storm sewer</i>		\$200,000
5.	(124) Grade Separation on County Rd. 435 <i>Phase I - Develop preliminary design to determine the preferred structure location Phase II - Construct grade separation over UP Railroad & U.S. Hwy. No. 30</i>		\$7,000,000
6.	(132) Jeffery Road Paving Improvements <i>Street paving improvements on Jeffery Road from 700' south of Prospect Rd to 1450' south of Prospect Road</i>		\$130,000
7.	(134) Liberty Drive Extension <i>Street paving improvements on Liberty Drive from 13th Street to Buffalo Bend</i>		\$300,000
8.	(133) Patriot Drive, Independence Ave, 20th Street and Freedom Drive <i>Storm sewer and cement pavement on 20th Street and areas north of 20th Street</i>		\$625,000
9.	(138) Extension of Commerce Road West of U.S. Highway 283 <i>Street paving from U.S. Highway 283, 450' west and 400' frontage road to the north</i>		\$225,000
10.	(139) Frontier Street Paving Improvements <i>Street paving from 200' west of U.S. Highway 283, 900' west, with storm sewer improvements</i>		\$300,000
11.	(98) Miscellaneous Panel Replacement Projects <i>Locations to be determined as funds are available.</i>		\$100,000
12.	(99) Miscellaneous Handicap Sidewalk Ramp Improvements <i>Locations to be determined as funding becomes available.</i>		\$50,000
13.	(109) Various Section of Hike/Bike Trails within the Community <i>Paving of various sections of the Master Trail Plan</i>		\$200,000
14.	(115) 6th Street Asphalt Overlay Improvements from Lincoln Street to Taylor Street <i>Asphalt overlay to improve the driving profile w/HC ramp improvements</i>		\$145,000
15.	(135) Frontage Road along Highway No. 283 <i>Paving improvements from the south line of the Lexington Opportunity Center parking lot 275' south to the median break in U.S. Highway No. 283</i>		\$80,000

SIX YEAR PLAN		
Program No.	Project and Description	Estimated Project Cost
1. (51)	Bridge over City Drainage Ditch <i>Replacement of bridge over the City drainage ditch approximately ½ mile east of U.S. Hwy 30 and Taft Street.</i>	\$80,000
2. (84)	Taft Street Paving Improvements <i>Rehabilitation of concrete paving on Taft Street from 6th Street north to 13th Street.</i>	\$325,000
3. (85)	Walnut Street Overlay Project <i>Paving improvements of existing asphalt street from near U.S. Hwy 283 to ½ mile east.</i>	\$600,000
4. (94B)	West Frontier Road Paving <i>Paving improvements from South Adams Street east to Wal-Mart development.</i>	\$490,000
5. (98)	Miscellaneous Panel Replacement Projects <i>Locations to be determined as funds are available.</i>	\$500,000
6. (99)	Miscellaneous Handicap Sidewalk Ramp Improvements <i>Locations to be determined as funding becomes available.</i>	\$500,000
7. (109)	Various Section of Hike/Bike Trails Within the Community <i>Paving of various sections of the Master Trail Plan</i>	\$1,000,000
8. (111)	20th Street from Independence Avenue to Airport Road <i>Paving & Storm Sewer Improvements</i>	\$325,000
9. (112)	Independence Avenue Paving Improvements <i>Starting 1250' North of 15th Street, 1300' North to 20th Street</i>	\$325,000
10. (116)	Paving on South Adams from Prospect to Frontier Street Extended <i>Street paving to provide access to South Adams Street and Frontier Street</i>	\$425,000
11. (117A)	Airport Road Paving Improvements <i>Airport Road paving from 20th Street intersection north 1000' to Corporate Limits</i>	\$130,000
12. (127)	Adams Street Lighting Improvements and Box Culvert Construction <i>Install new street lighting from Santa Fe to Elm Street Mill existing surface and overlay with 3" asphalt from Santa Fe to Walnut Street Construct a new box culvert on Drainage Ditch No. 1 at south corporate limits</i>	\$475,000
13. (128)	Erie Street Lighting Improvements & 13th Street Paving and Lighting Improvements <i>Install new street lighting along Erie Street from US Highway 30 north to 13th Street</i>	\$150,000
14. (129)	20th Street & Polk Street Paving and Lighting Improvements <i>Replace substandard paving panels on 20th Street along with sidewalk/HC ramp improvements Replace substandard paving panels on Polk Street along with sidewalk/HC ramps and new lighting</i>	\$525,000
15. (136)	Extension of East 17th Street from 160' East of Grant Street to Jefferson Street <i>Street paving and lighting on 17th and Jefferson Streets</i>	\$200,000
16. (137)	Extension of Fillmore Street North to 16th Street and 16th Street East to Monroe Street <i>Street paving and lighting on Fillmore and 16th Streets</i>	\$150,000
17. (140)	15th Street Turnaround <i>Construct a turnaround on the end of 15th Street, 150' west of Liberty Drive</i>	\$30,000
18. (141)	Loop Drive on the South Side of 20th Street West of Independence Avenue <i>30' wide concrete paving of a loop drive south of 20th Street with storm sewer improvements at the southern limits</i>	\$175,000
19. (142)	Extension of Patriot Drive to the Northwest and Turning South to 20th Street <i>30' wide concrete paving on an extension of Patriot Drive and interconnecting streets north of 20th Street with storm sewer improvements</i>	\$675,000

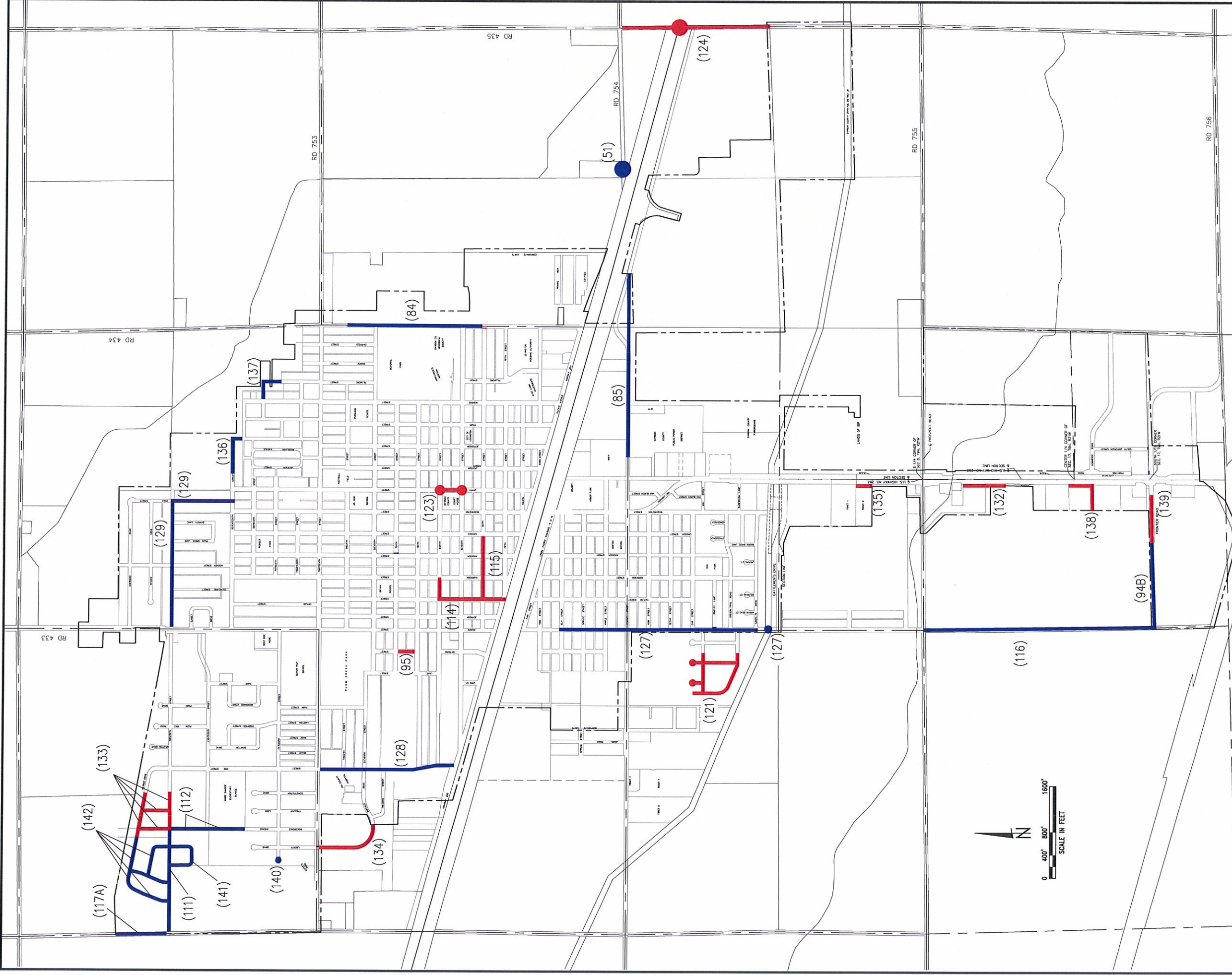

CITY OF LEXINGTON
ONE AND SIX YEAR IMPROVEMENT PLAN
2015 THRU 2020

LEGEND

PROJECTS IN THE ONE YEAR PLAN █

PROJECTS IN THE SIX YEAR PLAN █

ADDITIONAL PROJECTS IN THE PLAN

- (98) – MISCELLANEOUS PANEL REPLACEMENT PROJECTS
- (99) – MISCELLANEOUS SIDEWALK HANDICAP IMPROVEMENTS
- (109) – MISCELLANEOUS HIKE/BIKE TRAILS AROUND THE COMMUNITY