



PLUM CREEK PRKWY



PREPARED BY:



MILLER & ASSOCIATES
CONSULTING ENGINEERS, P.C.
1111 CENTRAL AVENUE
KEARNEY, NE 68847

OPPORTUNITY CENTER SOUTH

DRAWINGS FOR

2015 OPPORTUNITY CENTER SOUTH PAVING IMPROVEMENTS

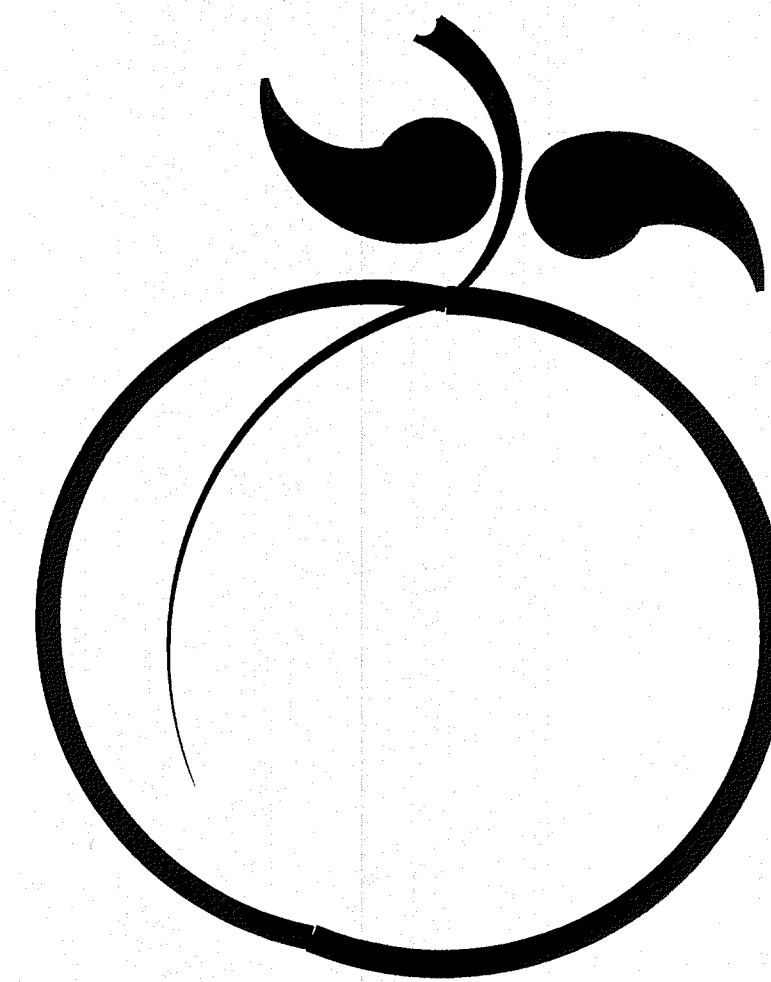

INDEX OF DRAWINGS	
SHT. NO.	DESCRIPTION
1	TITLE SHEET & INDEX
2	TYPICAL SECTIONS
3-4	STREET PLAN & PROFILES
5	PAVING DETAILS
6	HANDICAP RAMP DETAILS
X1-X3	CROSS SECTIONS

LEXINGTON, NEBRASKA

M&A PROJECT NO. 127-A1-101



MILLER & ASSOCIATES Consulting Engineers P.C.
1111 Central Avenue - Kearney, NE 68847



SET NO. _____

DRAWING NO. 30395

UTILITIES

GENERAL DIGGERS HOT LINE
8-1-1

G:\Projects\127\127-A1-101\Cad-Dwg\Sheet Drawings\PHASE 2 IMPROVEMENTS\SH1 DETAILS.dwg
 PLOTTED: 8/31/2015 2:55 PM
 SAVED: 8/31/2015 2:54 PM

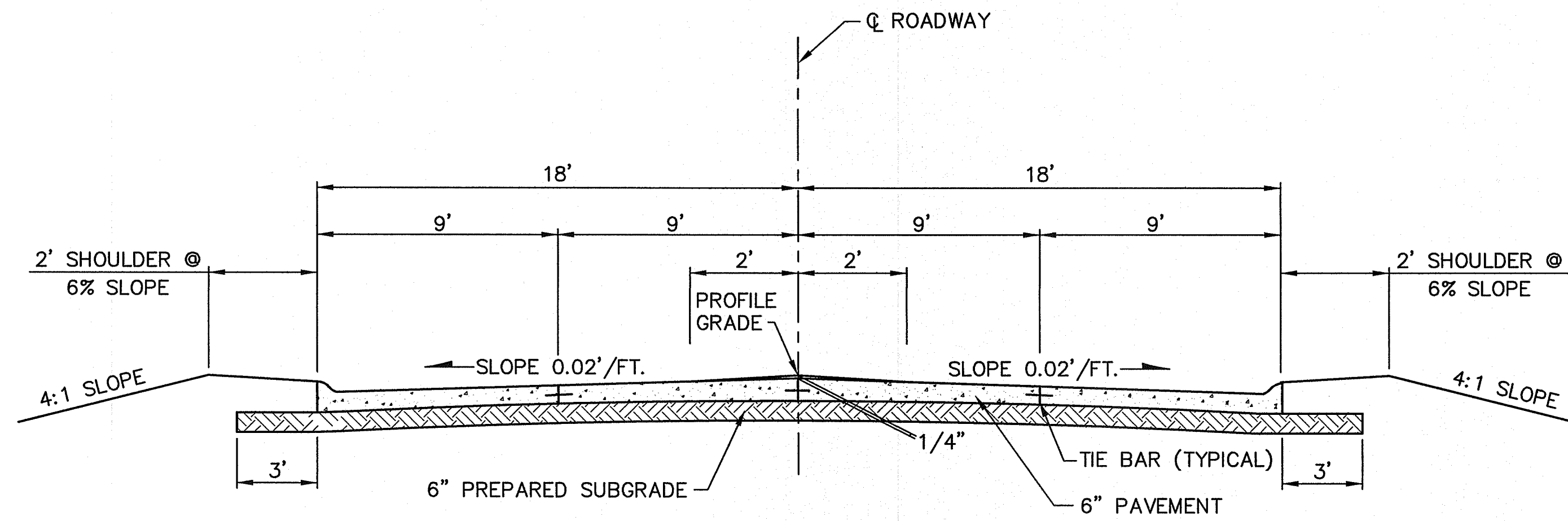

36' TANGENT SLAB PAVEMENT - STREET A
NO SCALE

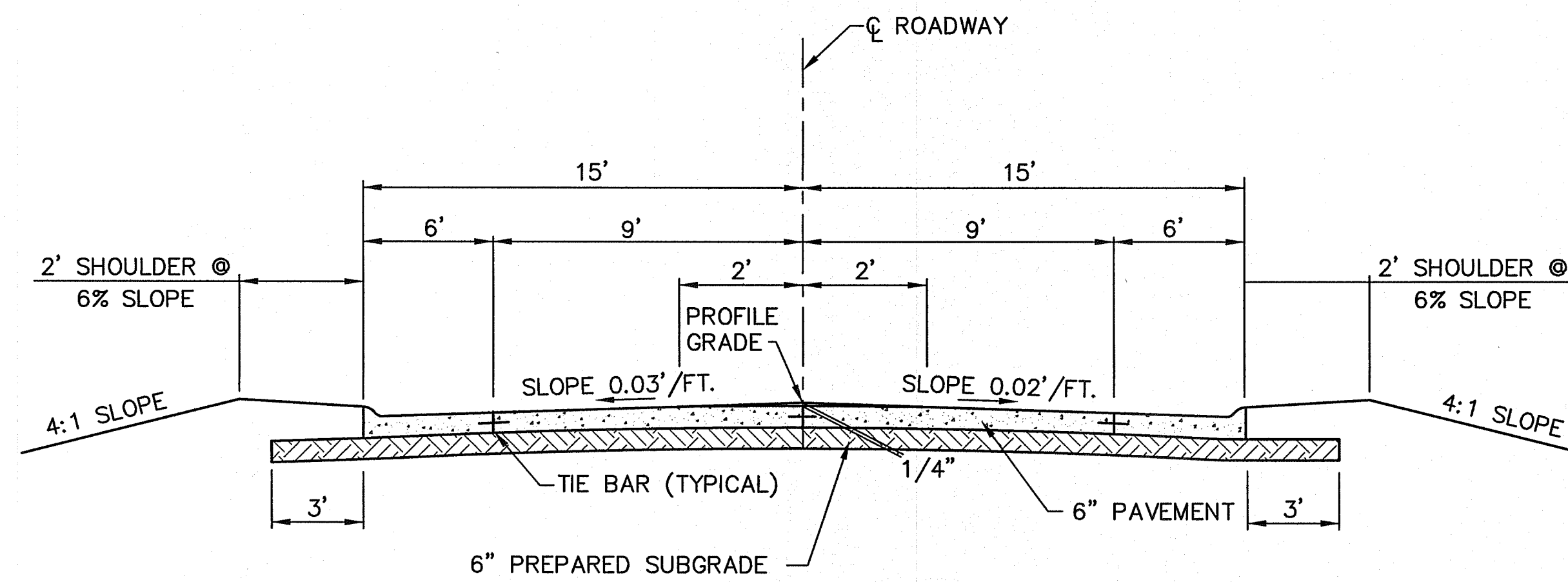

30' TANGENT SLAB PAVEMENT - STREET B
NO SCALE

REVISIONS	BY

M&A
 Miller & Associates
 Consulting Engineers, P.C.
 Kearney, NE (308) 234-6456
 McCook, NE (308) 345-3710

2015 OPPORTUNITY CENTER SOUTH PAVING IMPROVEMENTS
TYPICAL SECTIONS
 LEXINGTON, NEBRASKA

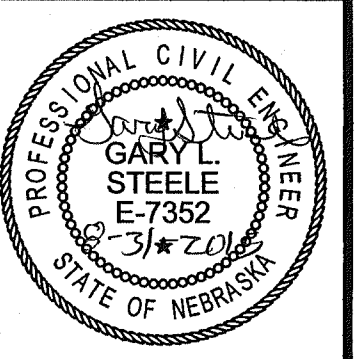

VERIFY SCALES	
BAR IS ONE INCH ON ORIGINAL DRAWING	
0 = 1"	
IF NOT ONE INCH ON THIS SHEET, ADJUST SCALES ACCORDINGLY.	
SCALE: NOT TO SCALE	
PROJECT NO. 127-A1-101	
DATE: AUGUST, 2015	
FIELD BOOK	M&A DWG NO. 30394
DRAWN BY: LMA	APRVD BY:
SHEET 2	

This document, and the ideas and designs incorporated herein, are the property of Miller & Associates and is not to be used in whole or in part, for any other project without the written authorization of Miller & Associates.



2015 OPPORTUNITY CENTER SOUTH PAVING IMPROVEMENTS
STREET A PLAN & PROFILE
 LEXINGTON, NEBRASKA

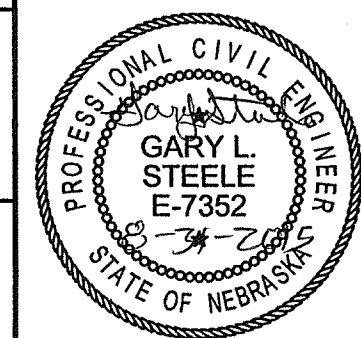

VERIFY SCALES
 BAR IS ONE INCH ON ORIGINAL DRAWING
 IF NOT ONE INCH ON THIS SHEET, ADJUST SCALES ACCORDINGLY.
 SCALE: 1"=20' HORZ
 1"=2' VERT
 PROJECT NO. 127-AI-101
 DATE: AUGUST, 2015
 FIELD BOOK M&A DWG NO. 30393
 DRAWN BY: LMA APRVD BY: LMA
 SHEET 3

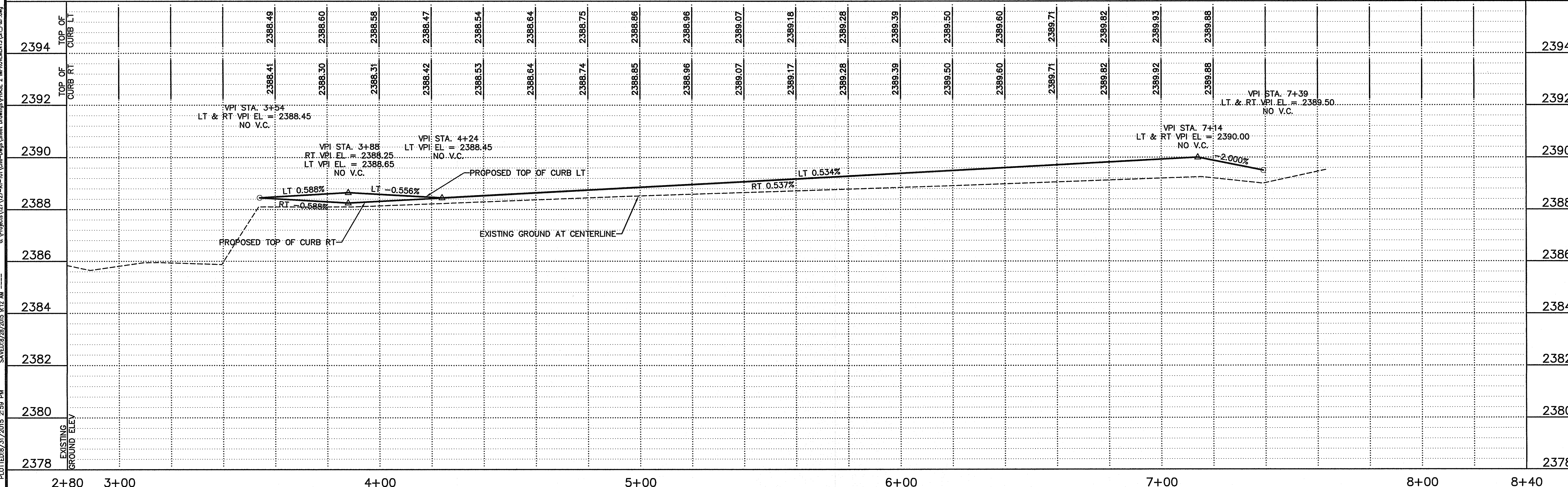
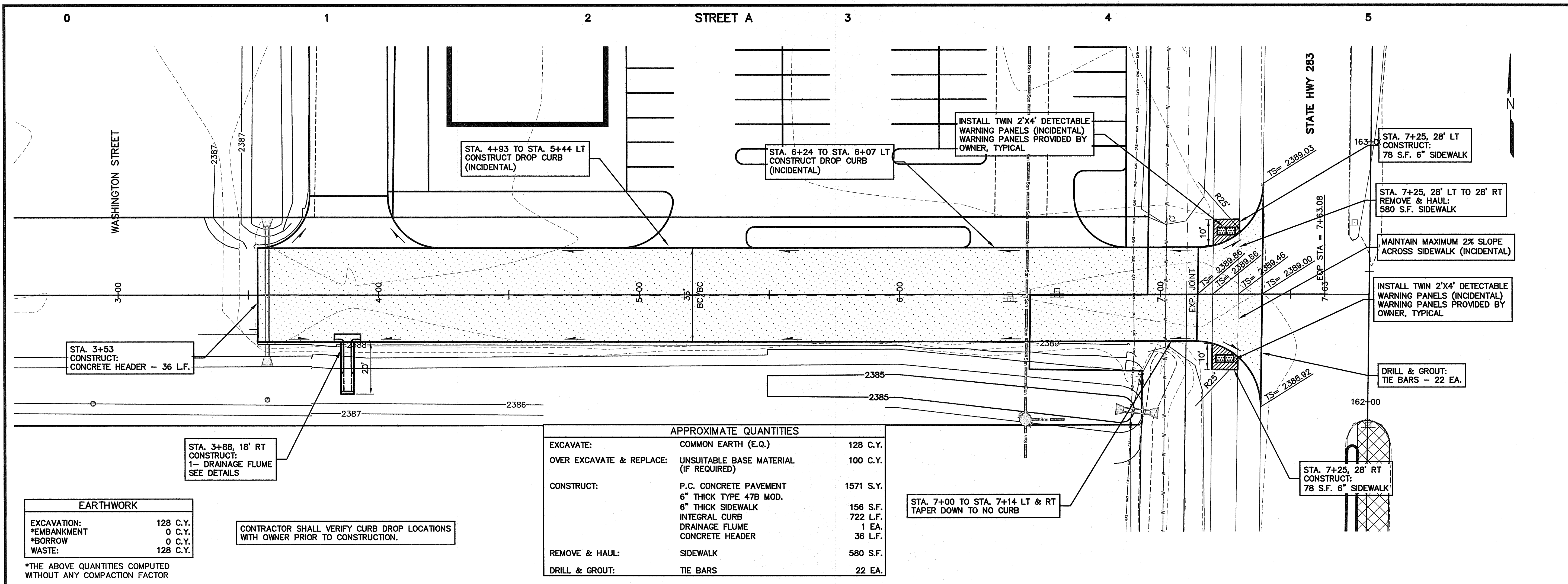

PLOTTED: 8/31/2015 2:59 PM
 SAVED: 8/28/2015 9:12 AM
 C:\Projects\127-AI-101\Drawings\Sheet Drawings\PHASE 2 IMPROVEMENTS\SU1.PDF

2015 OPPORTUNITY CENTER SOUTH PAVING IMPROVEMENTS
STREET B PLAN & PROFILE
 LEXINGTON, NEBRASKA

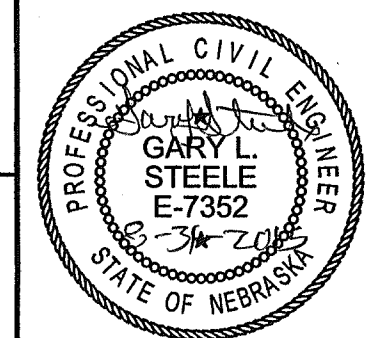

VERIFY SCALES
 BAR IS ONE INCH ON ORIGINAL DRAWING
 IF NOT ONE INCH ON THIS SHEET, ADJUST SCALES ACCORDINGLY.
 SCALE: 1"=20' HORZ
 1"=2' VERT
 PROJECT NO. 127-A1-101
 DATE: AUGUST, 2015
 FIELD BOOK M&A DWG NO. 30392
 DRAWN BY: LMA APRVD BY: [Signature]
 SHEET 4

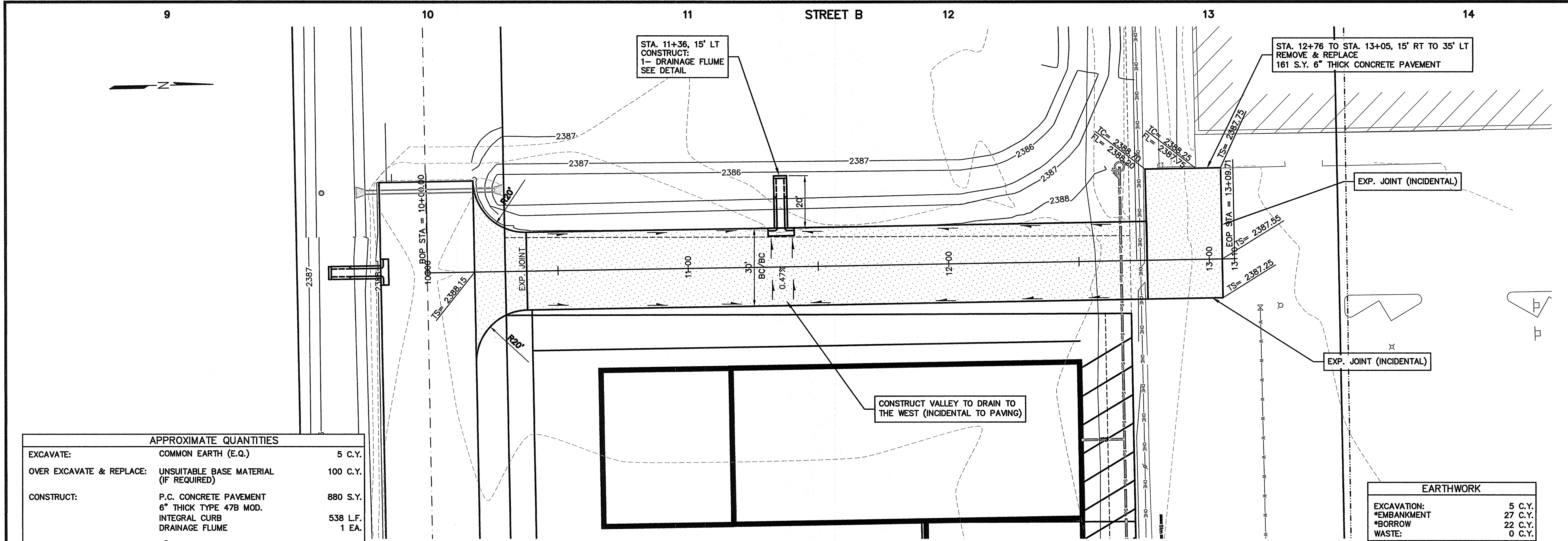

APPROXIMATE QUANTITIES

EXCAVATE:	COMMON EARTH (E.Q.)	5 C.Y.
OVER EXCAVATE & REPLACE:	UNSATURATED BASE MATERIAL (IF REQUIRED)	100 C.Y.
CONSTRUCT:	P.C. CONCRETE PAVEMENT	880 S.Y.
	6" THICK TYPE 47B MOD.	
	INTEGRAL CURB	538 L.F.
	DRAINAGE FLUME	1 EA.
REMOVE & REPLACE:	6" THICK CONCRETE PAVEMENT	161 S.Y.

EARTHWORK

EXCAVATION:	5 C.Y.
*EMBANKMENT	27 C.Y.
*BORROW	22 C.Y.
WASTE:	0 C.Y.

*THE ABOVE QUANTITIES COMPUTED WITHOUT ANY COMPACTION FACTOR

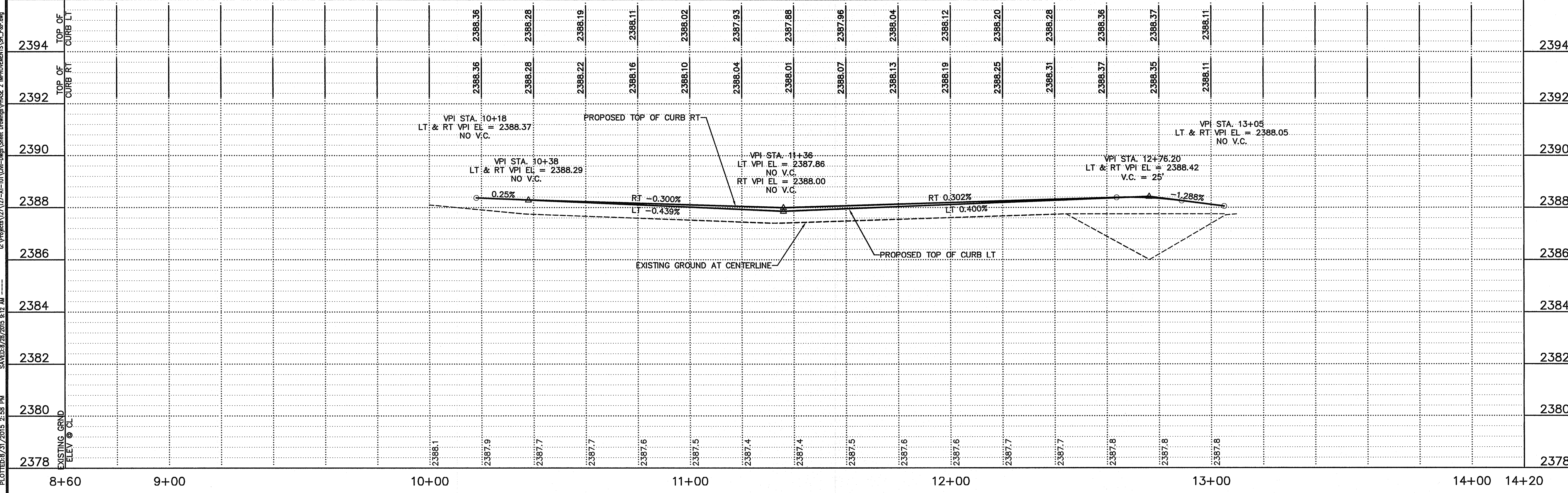

G:\Projects\127-A1-101\101-Cur-&Prop-Drawings\PHASE 2 IMPROVEMENTS\SLP.PDF.dwg
 SAVED: 8/29/2015 9:12 AM
 PLOTTED: 8/31/2015 2:58 PM

REVISIONS	BY

M&A
 Miller & Associates
 Consulting Engineers, P.C.
 Kearney, NE (308) 234-6456
 McCook, NE (308) 345-3710

2015 OPPORTUNITY CENTER SOUTH PAVING IMPROVEMENTS
PAVING DETAILS
 LEXINGTON, NEBRASKA



VERIFY SCALES
 BAR IS ONE INCH ON ORIGINAL DRAWING
 IF NOT ONE INCH ON THIS SHEET, ADJUST SCALES ACCORDINGLY.

SCALE: NOT TO SCALE
 PROJECT NO. 127-A1-101
 DATE: AUGUST, 2015
 FIELD BOOK M&A DWG NO. 30391
 DRAWN BY: LMA APRVD BY: LMA
 SHEET **5**

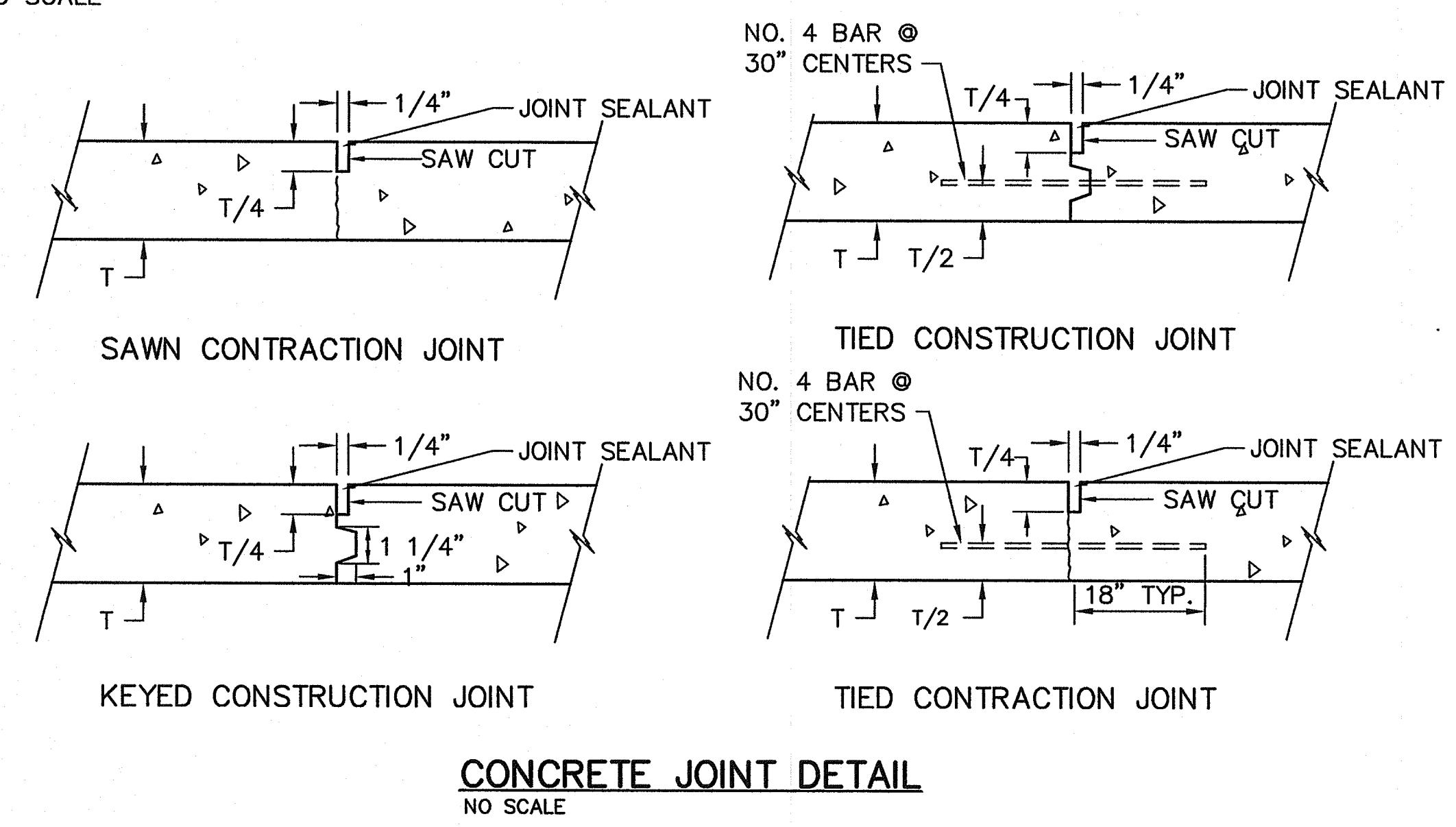
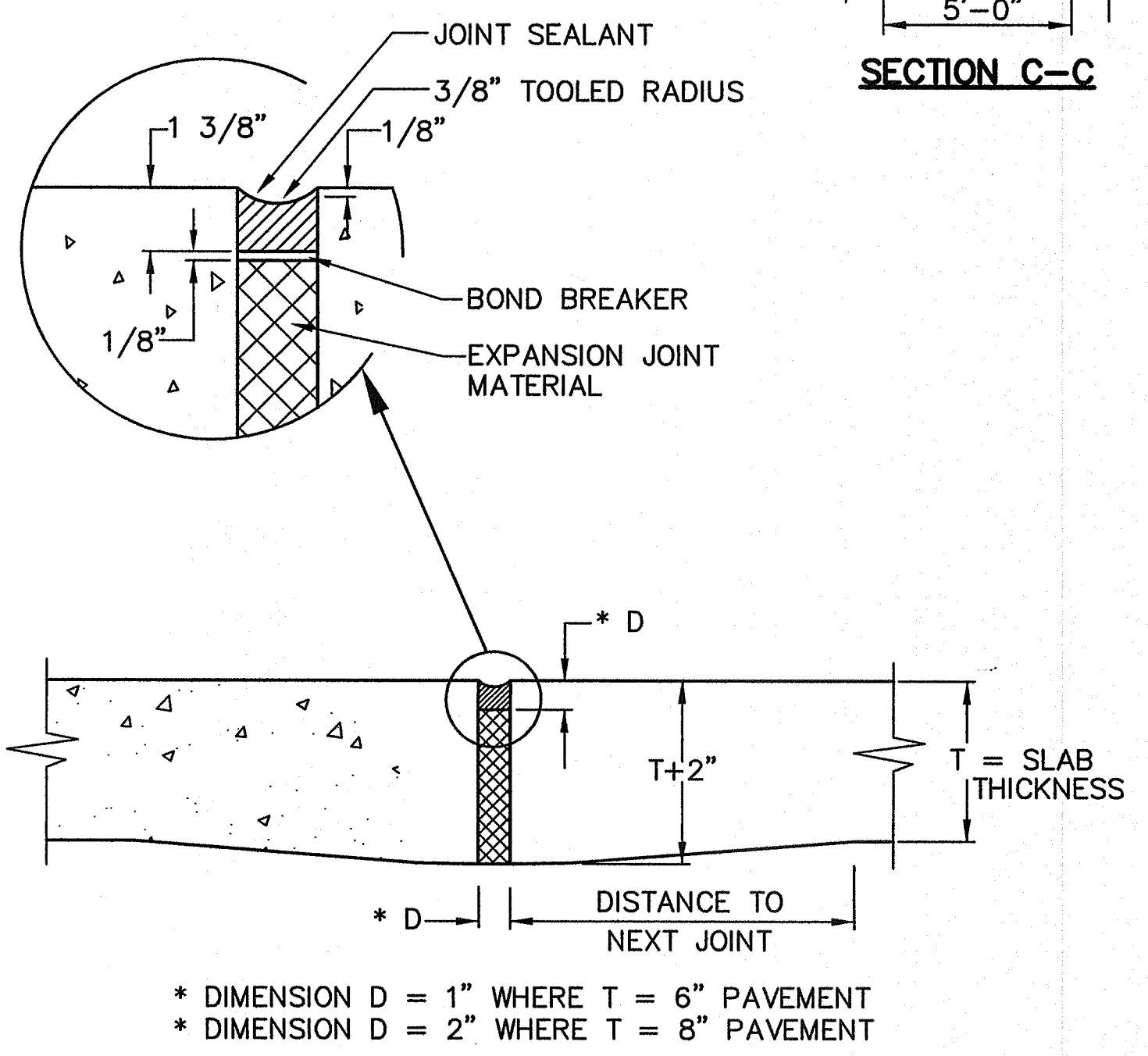
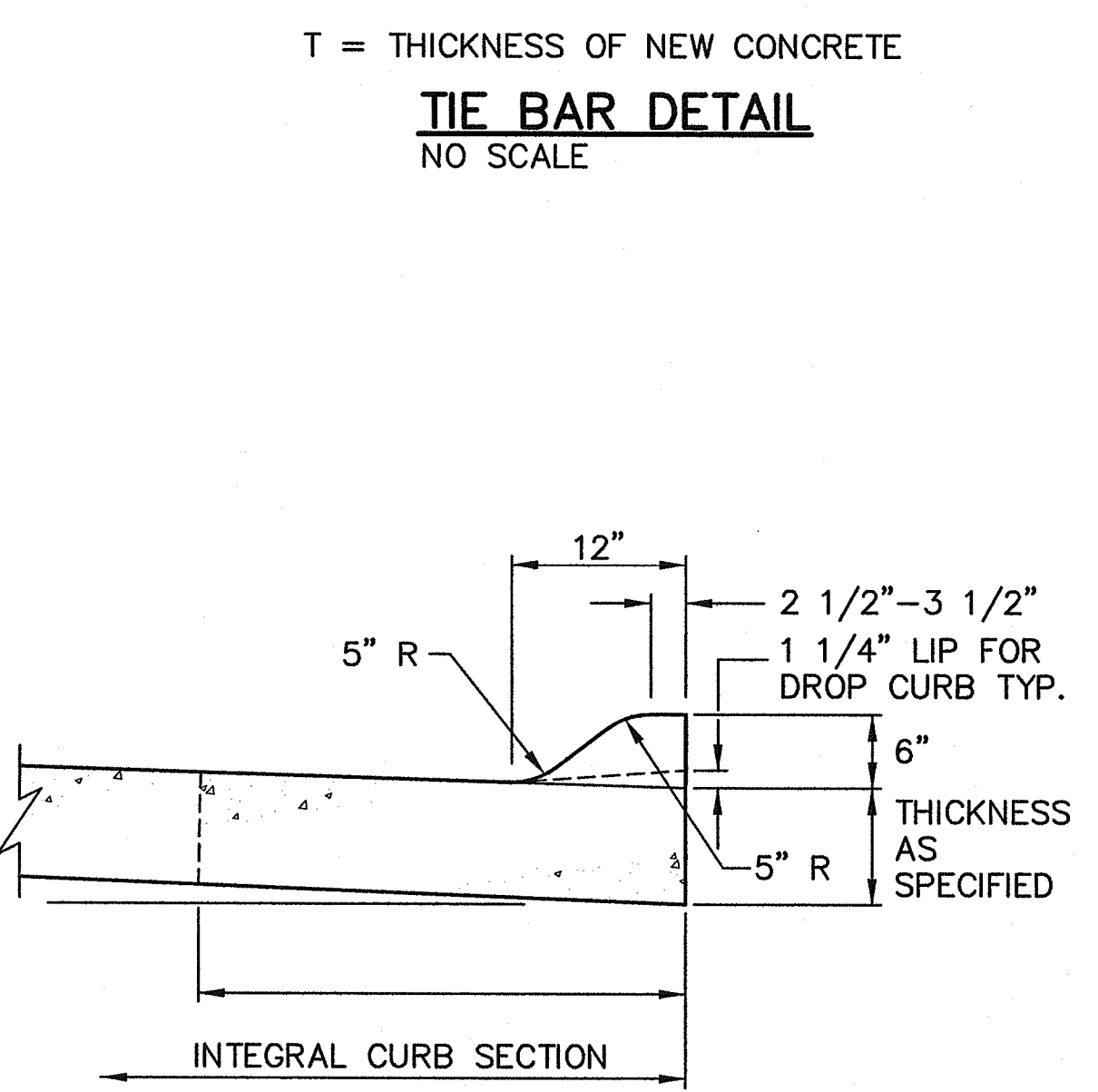
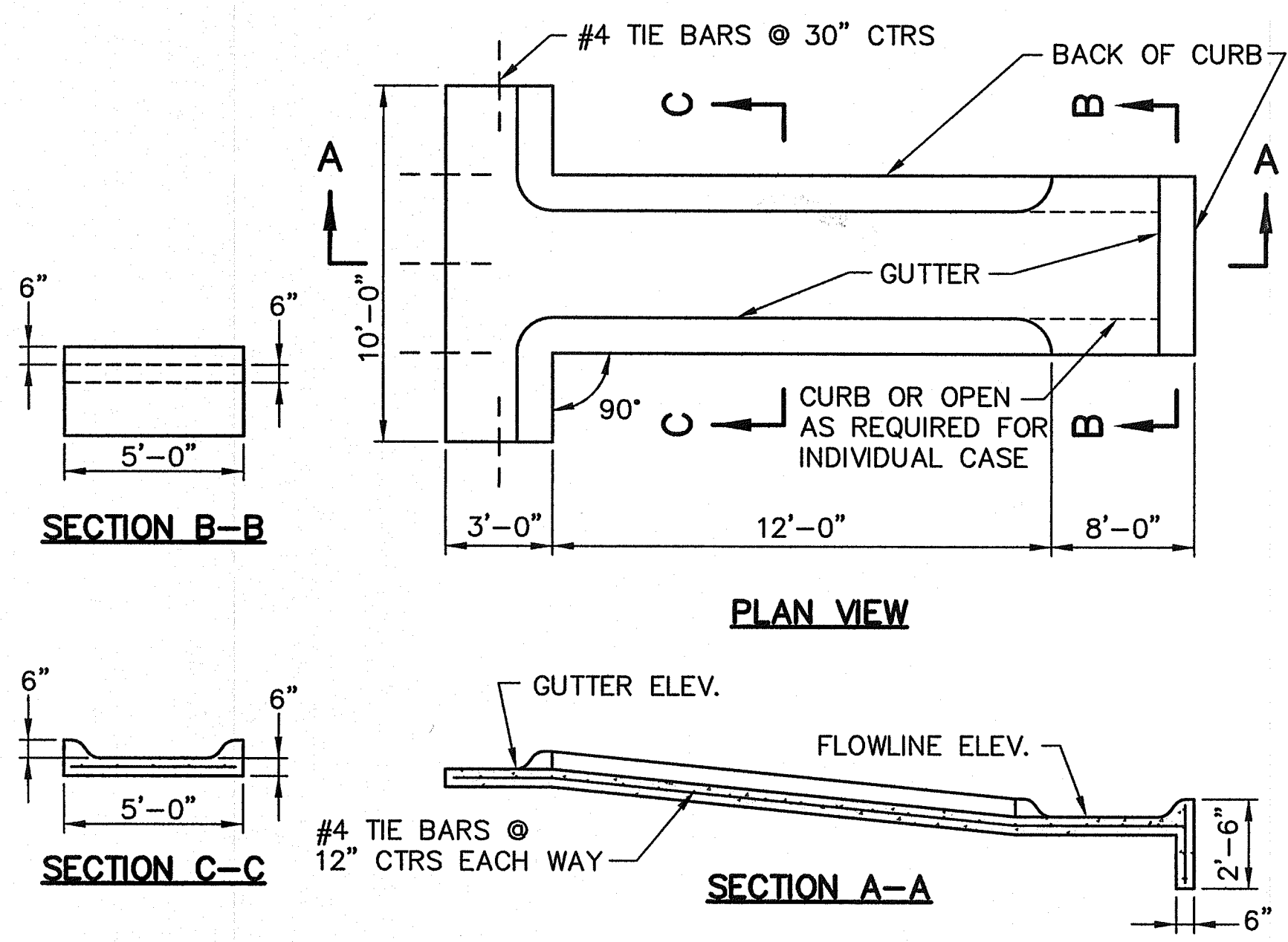
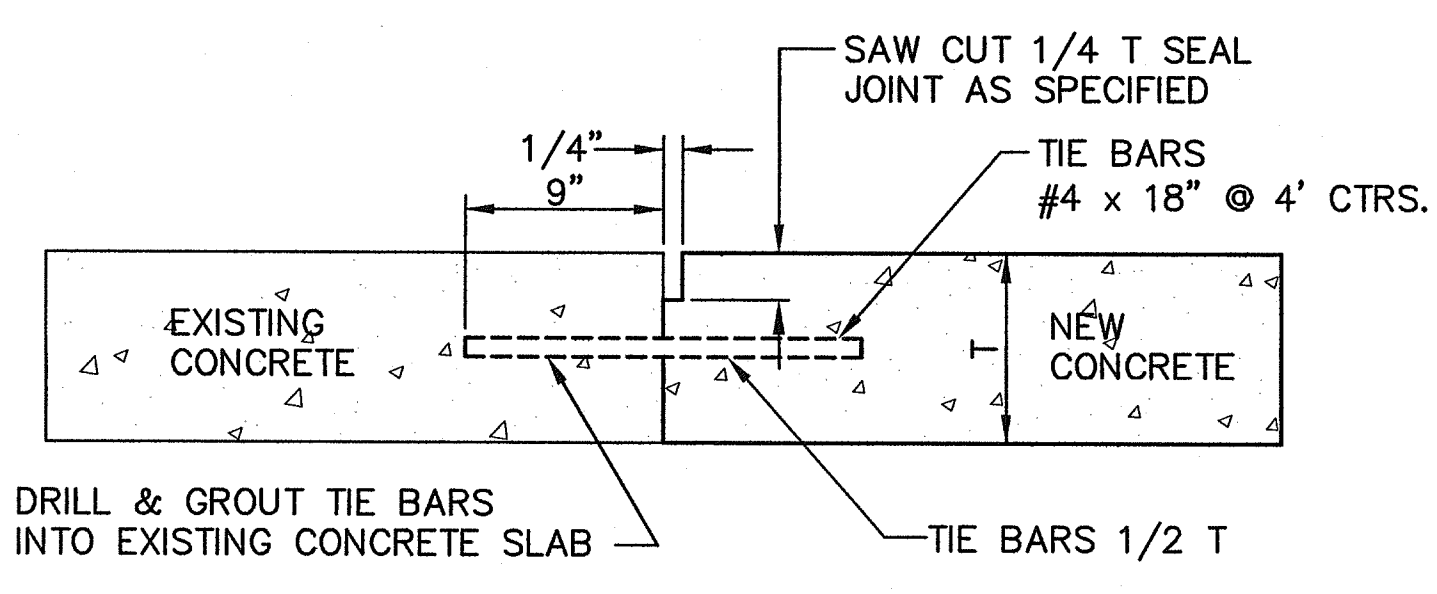
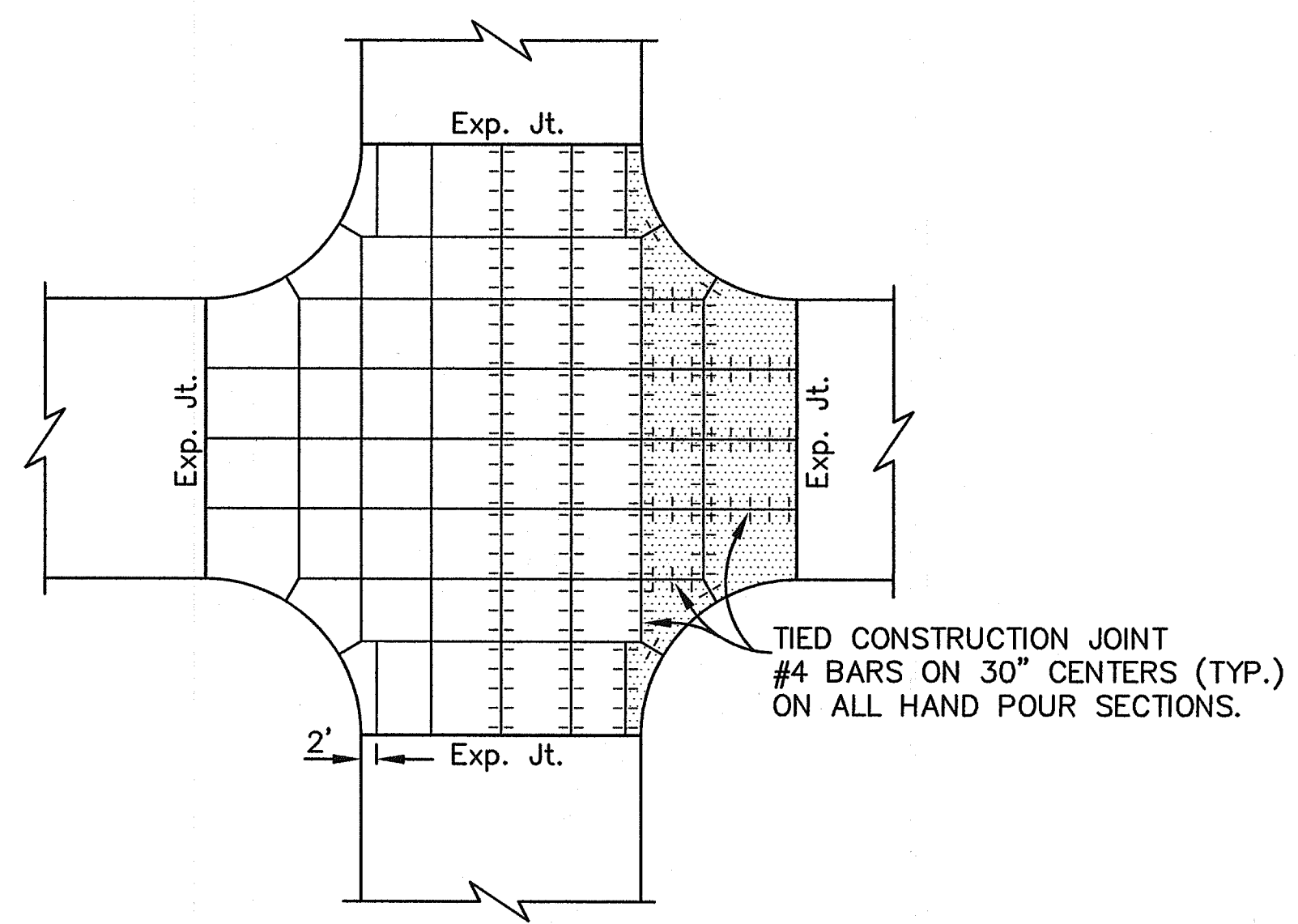
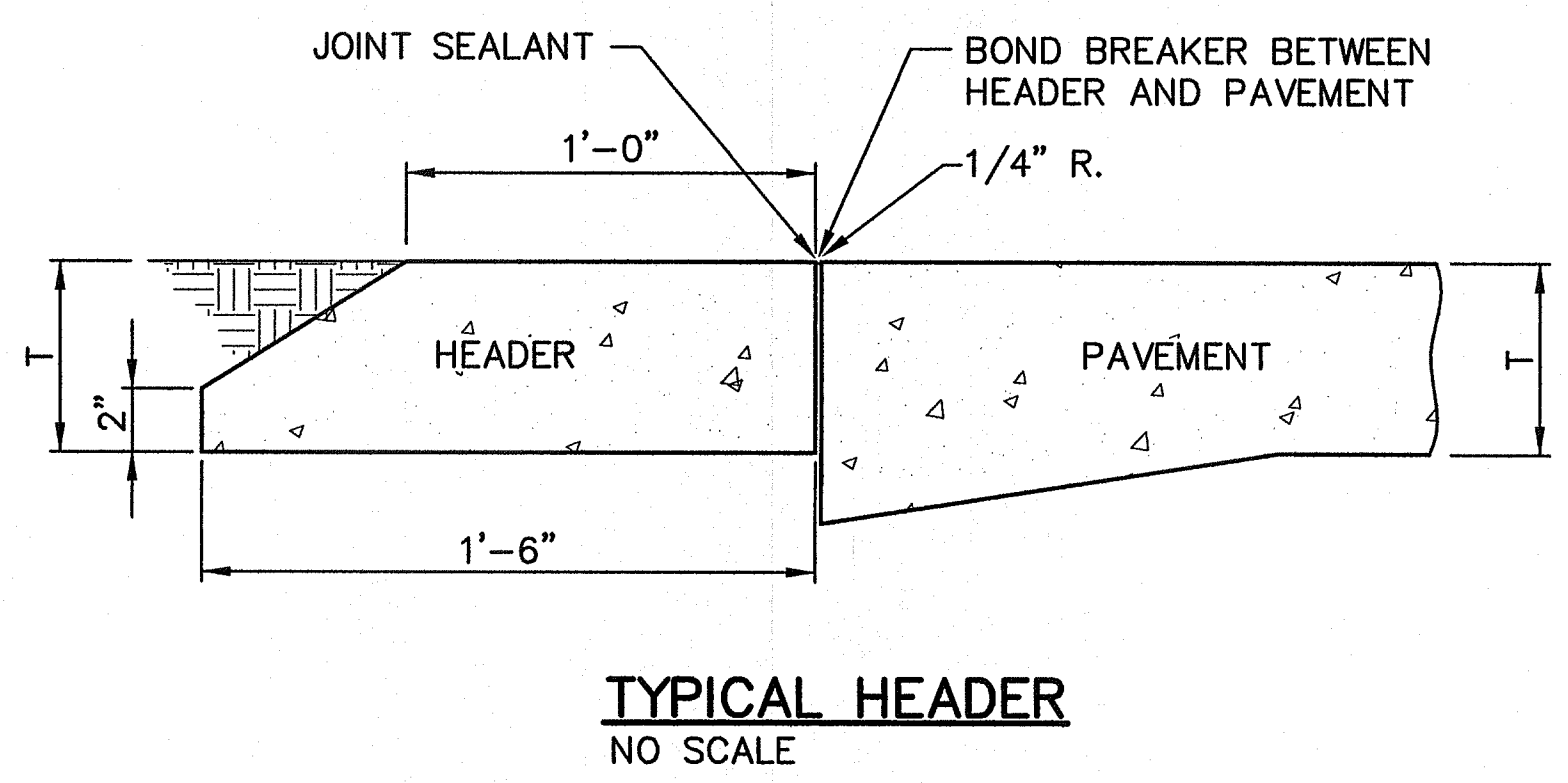
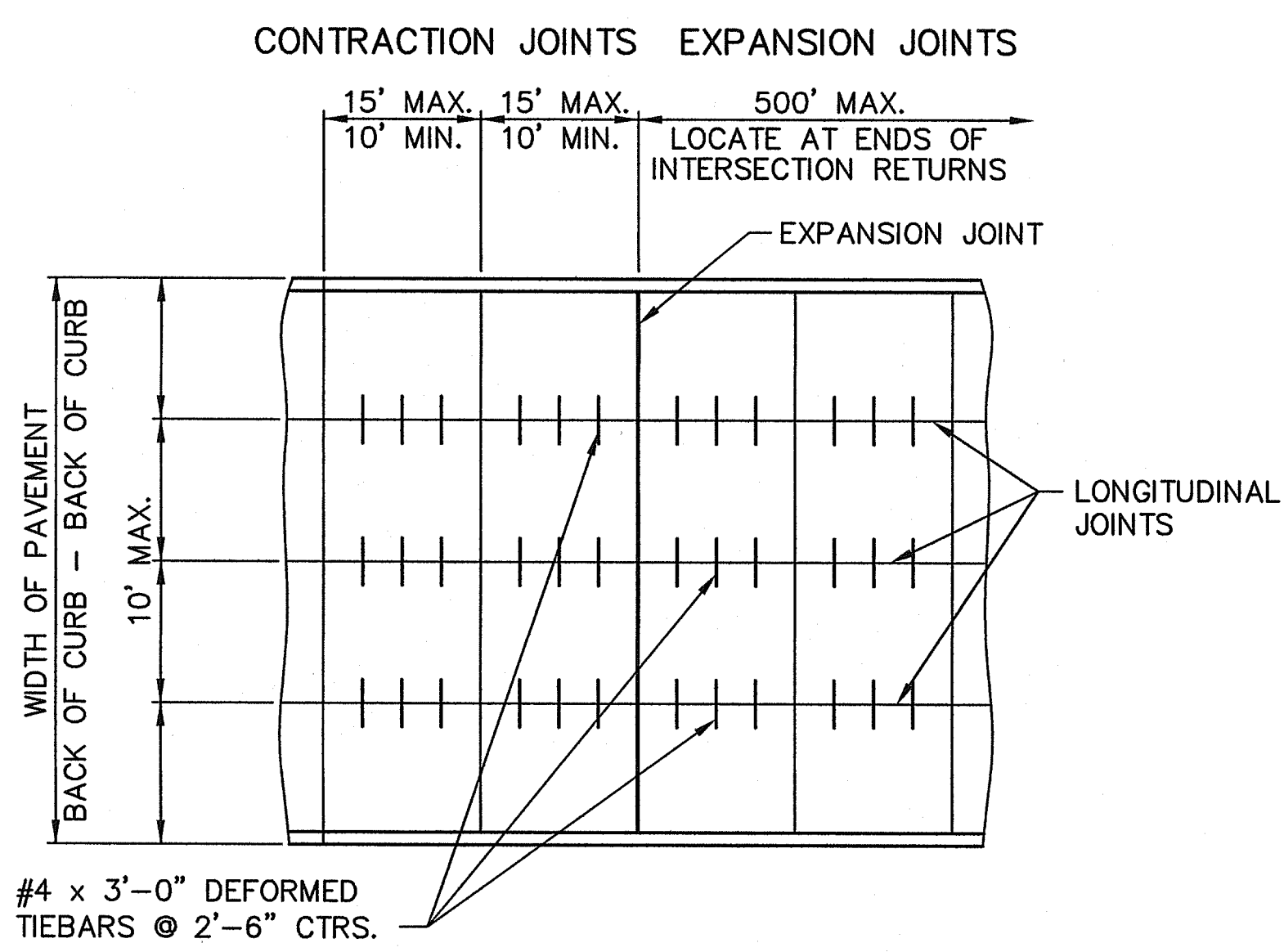

NOTE:
 EXTREME CARE SHALL BE USED IN FINISH WORK TO ELIMINATE "LOW SPOTS" AND "POCKETS" IN FLAT GRADES

G:\Projects\127\127-A1-101\Curbs\Drawings\Phase 2 IMPROVEMENTS\SI DETAILS.dwg
 PLOTTED: 8/31/2015 2:55 PM
 SAVED: 8/31/2015 2:54 PM

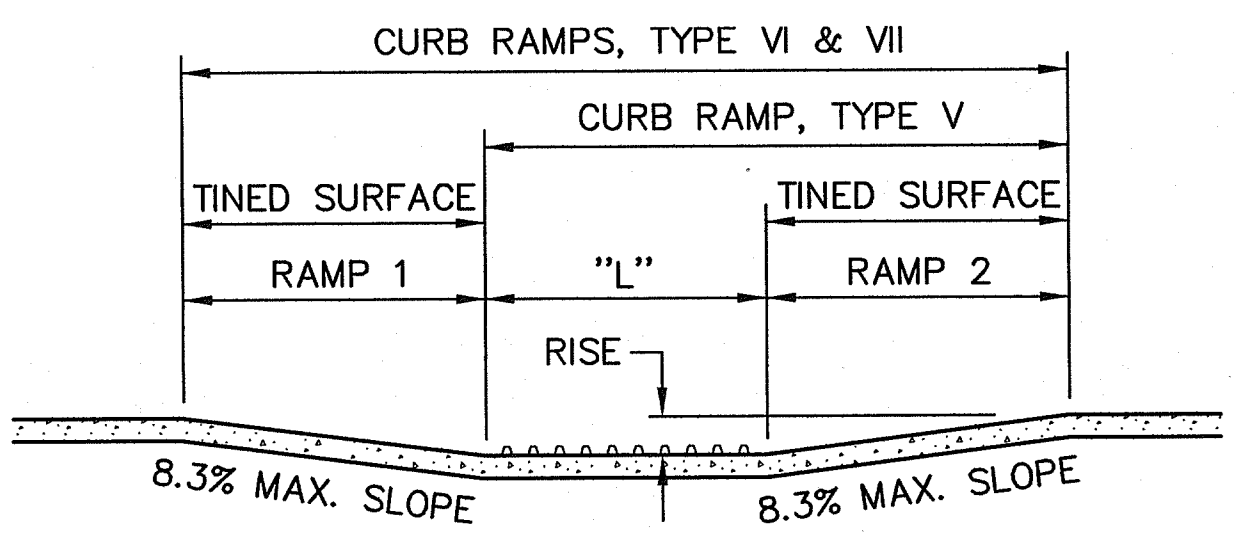
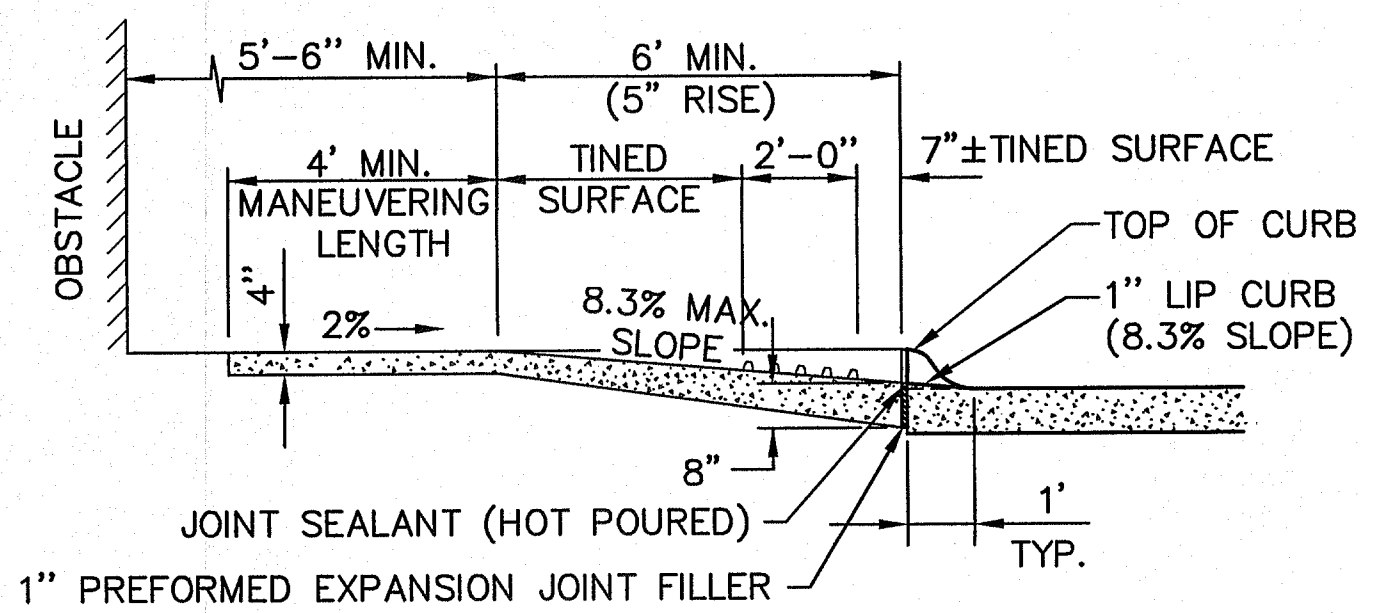
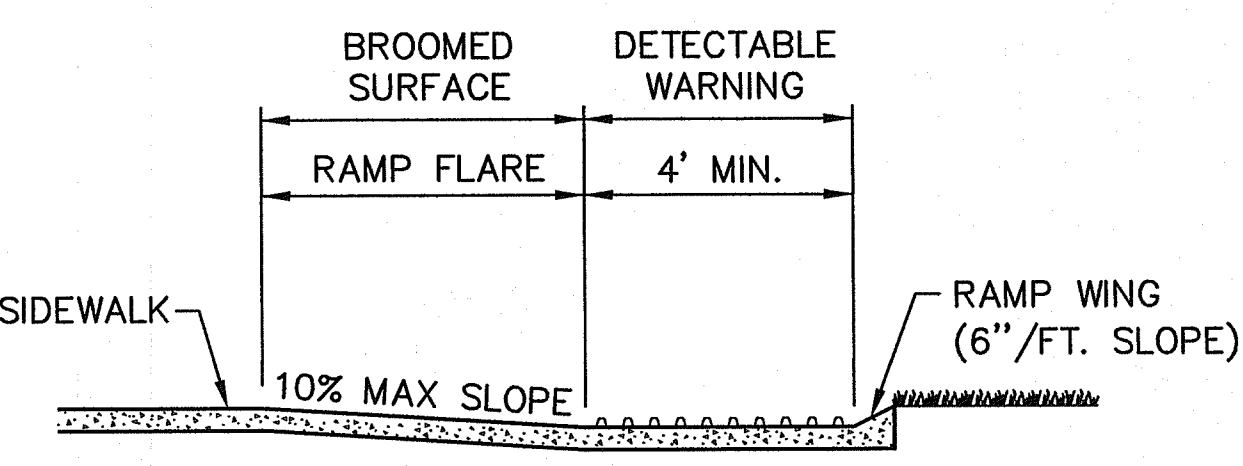
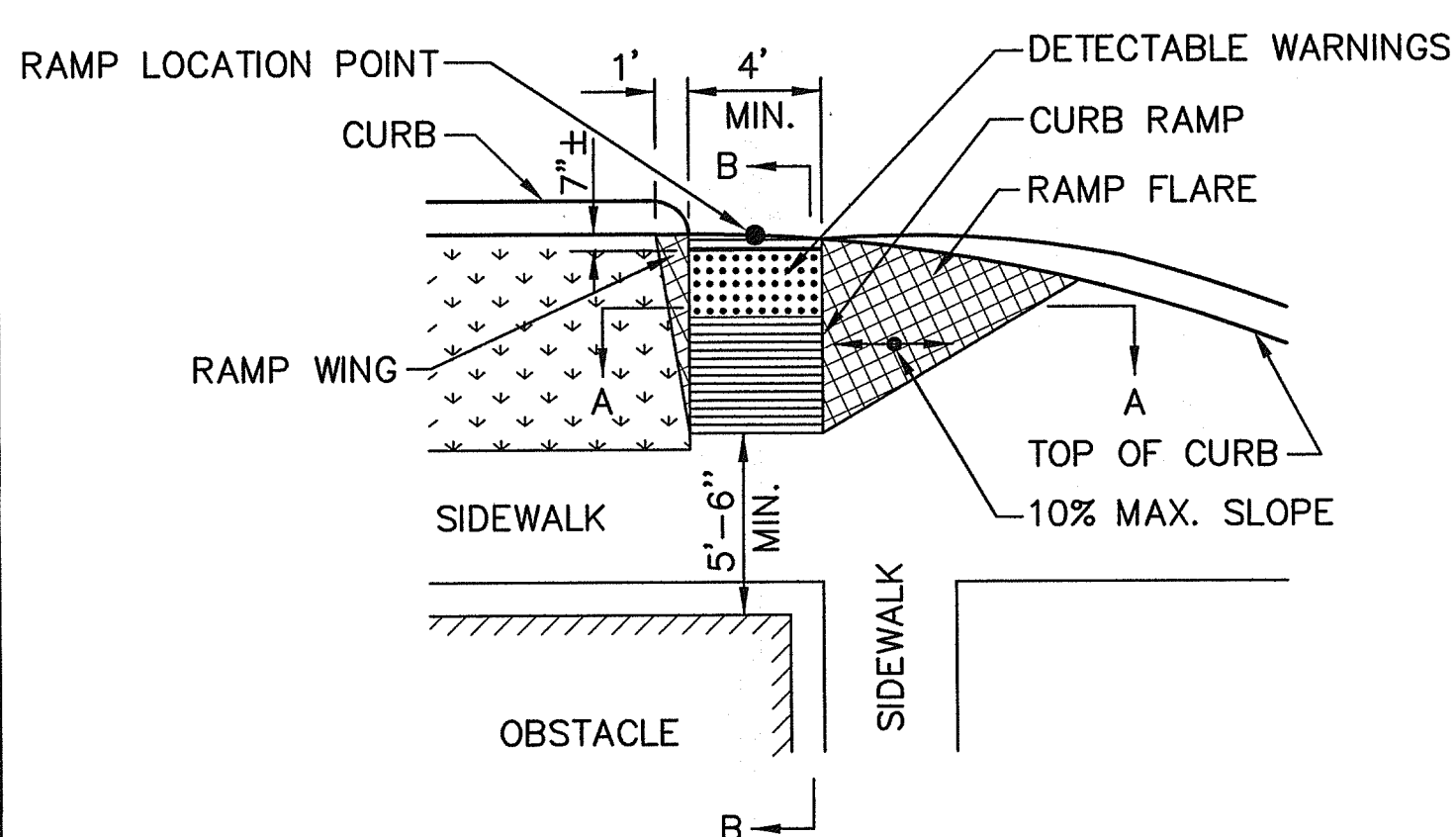
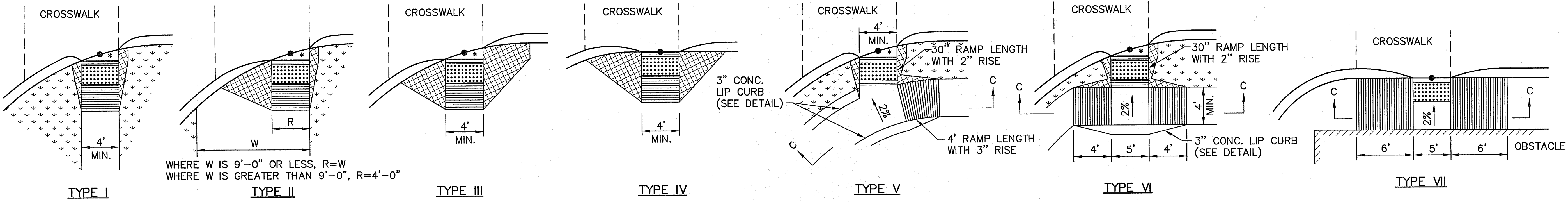

CURB RAMP	RISE	"L"	RAMP 1	RAMP 2
TYPE V	3"	VAR.	N/A	4'
TYPE VI	3"	5'	4'	4'
TYPE VII	5"	5'	6'	6'

TYPICAL CURB RAMP DETAIL

SECTION A-A
TYPICAL RAMP CROSS SECTION

SECTION B-B
TYPICAL RAMP PROFILE

SECTION C-C
TYPICAL RAMP CROSS SECTION

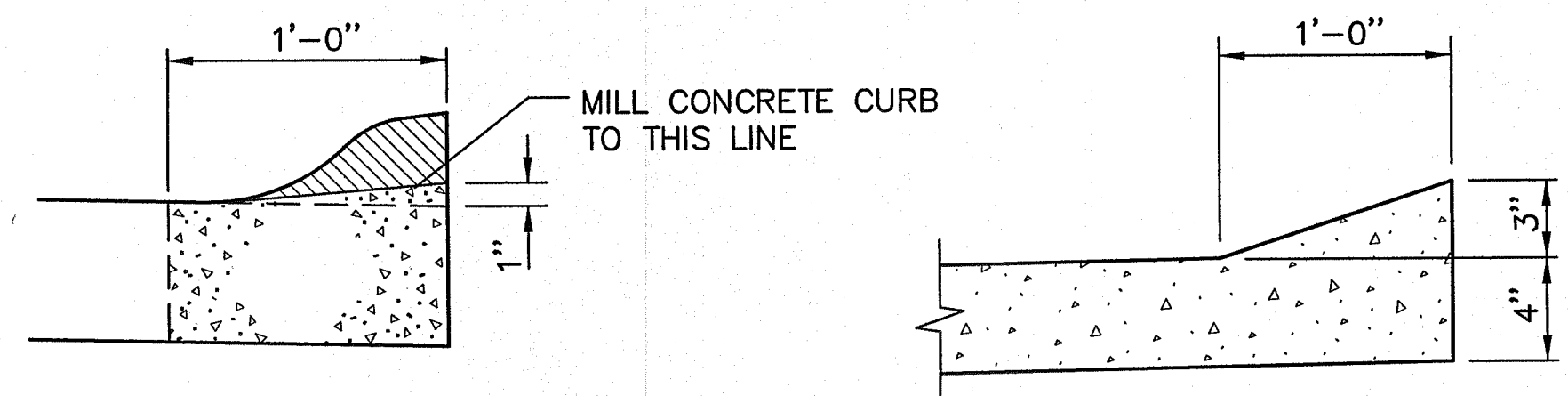
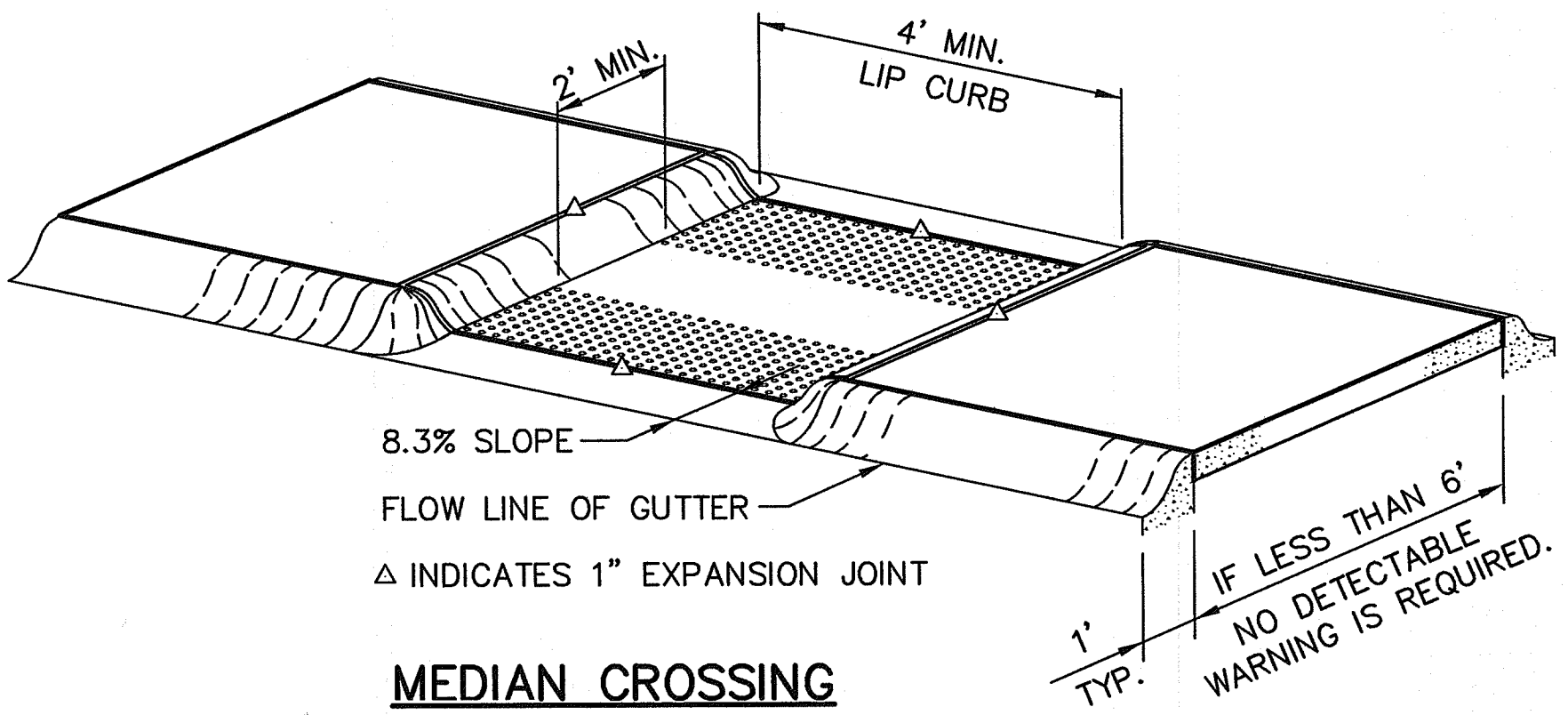

NOTE: COMBINATION CONCRETE CURB AND GUTTER MAY BE REMOVED AND REPLACED IN LIEU OF MILLING.

NOTES:

- THE NORMAL GUTTER LINE PROFILE SHALL BE MAINTAINED THROUGH THE AREA OF THE CURB RAMP.
- THE SURFACE OF ALL CURB RAMPS SHALL BE TINED TRANSVERSELY TO THE SLOPE OF THE CURB RAMP. THE TINES SHALL PRODUCE GROOVES APPROXIMATELY 1/8" WIDE AND 3/16" DEEP ON 1/2" CENTERS. ALL FLARES AND WINGS SHALL BE BROOMED.
- CARE SHALL BE TAKEN TO ASSURE A UNIFORM GRADE ON THE CURB RAMP, FREE OF SAGS AND SHORT GRADE CHANGES.
- THE RAMP FLARES SHALL BE CONSTRUCTED WITH A 10% SLOPE AT RIGHT ANGLES TO THE SLOPE OF THE CURB RAMP, TYPES II, III & IV.
- THE SLOPE OF SIDEWALKS APPROACHING CURB RAMPS (OR THEIR FLARES) SHALL BE FLAT ENOUGH TO PROVIDE RECOVERY AREAS FOR WHEELCHAIRS ENTERING OR EXITING THE RAMPS.
- THE WORK OF CONSTRUCTING THESE RAMPS SHALL BE MEASURED AND PAID FOR AS A PART OF THE WORK FOR "CONCRETE SIDEWALKS", "CONCRETE MEDIAN SURFACING" OR "CONCRETE BIKEWAY". THE WORK OF MODIFICATION OF NEW OR EXISTING CURB WILL NOT BE PAID FOR DIRECTLY, BUT WILL BE CONSIDERED SUBSIDIARY TO OTHER ITEMS OF WORK FOR WHICH DIRECT PAYMENT IS MADE.

LEGEND

- DETECTABLE WARNINGS
- TINED CURB RAMPS
- BROOMED RAMP WINGS & FLARES
- MILLED CONCRETE
- GRASS OR NON WALKING SURFACE

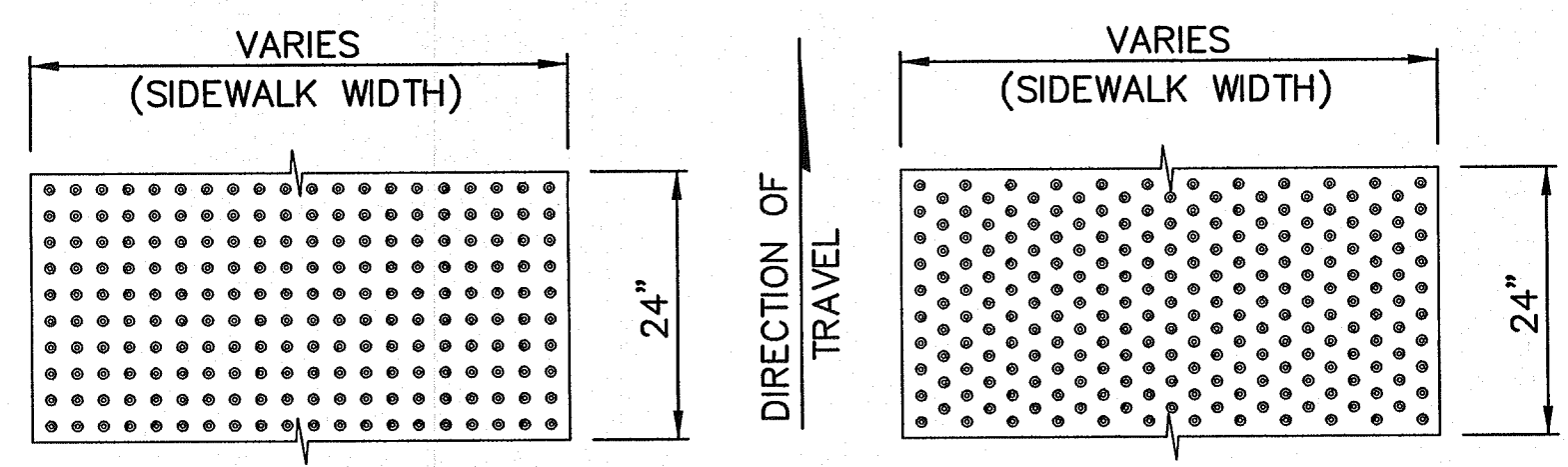
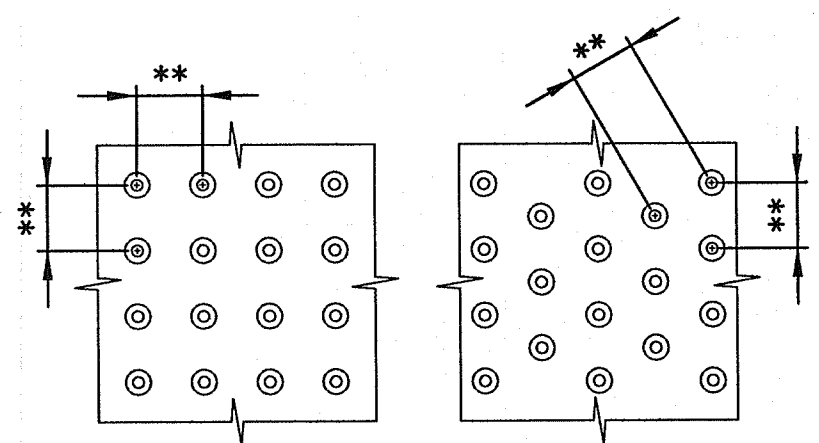
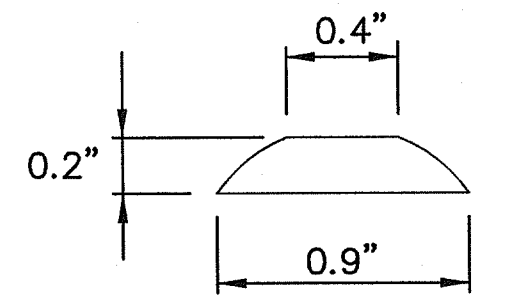

DOME SECTION

DOME SPACING

DOME ALIGNMENT

DETECTABLE WARNING DETAILS

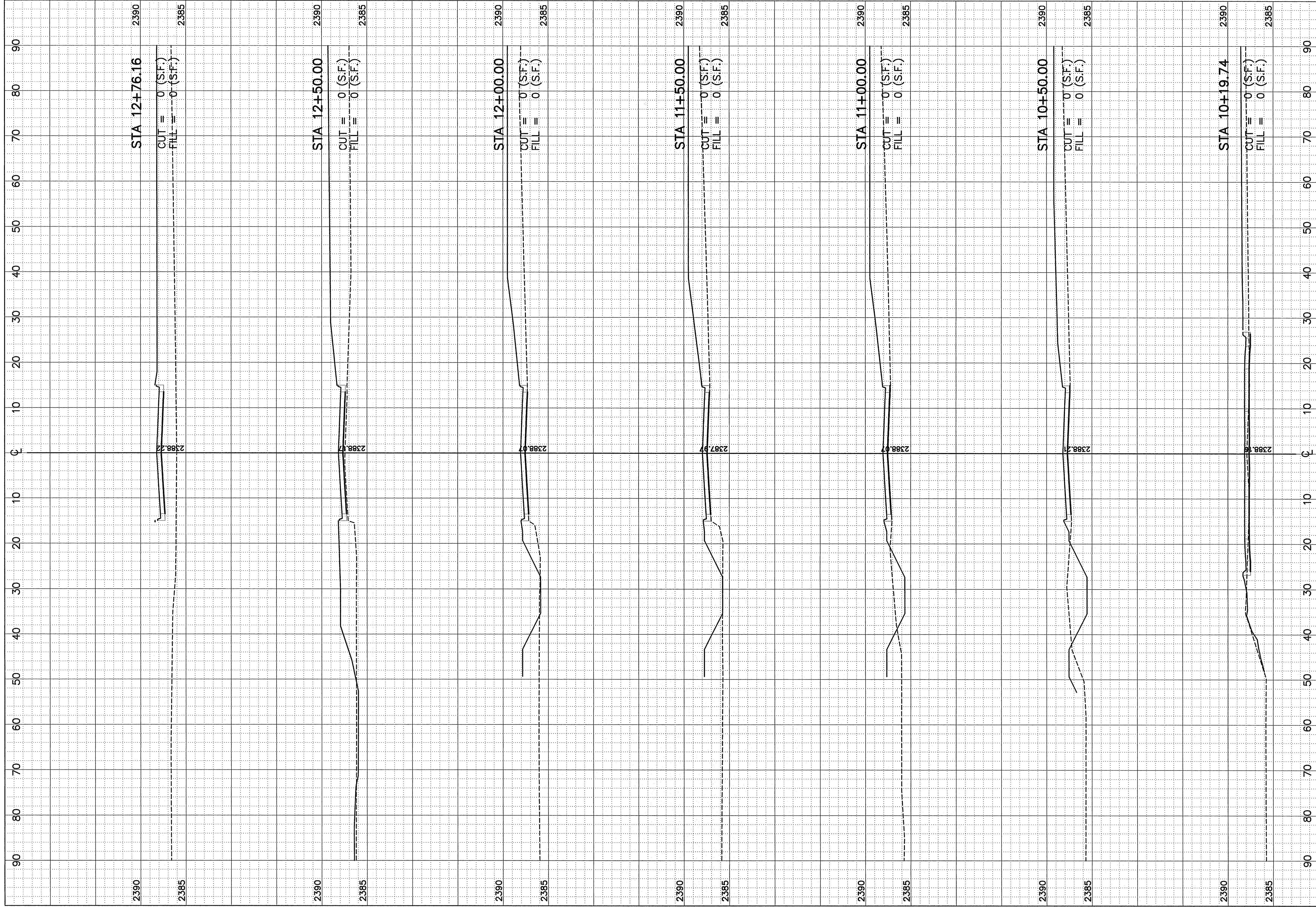

REVISIONS	BY



2015 OPPORTUNITY CENTER SOUTH PAVING IMPROVEMENTS
STREET B CROSS SECTIONS
 LEXINGTON, NEBRASKA

This document, and the ideas and designs incorporated herein, as an instrument of professional service, is the property of Miller & Associates and is not to be used in whole or in part, for any other project without the written authorization of Miller & Associates.

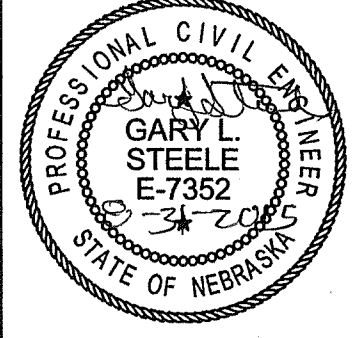

VERIFY SCALES	
BAR IS ONE INCH ON ORIGINAL DRAWING	
0 = 1"	
IF NOT ONE INCH ON THIS SHEET, ADJUST SCALES ACCORDINGLY.	
SCALE:	1"=5' VERT 1"=10' HORZ
PROJECT NO.	127-A1-101
DATE:	AUGUST, 2015
FIELD BOOK	M&A DWG NO. 30389
DRAWN BY:	LMA
APRVD BY:	
SHEET	X-1

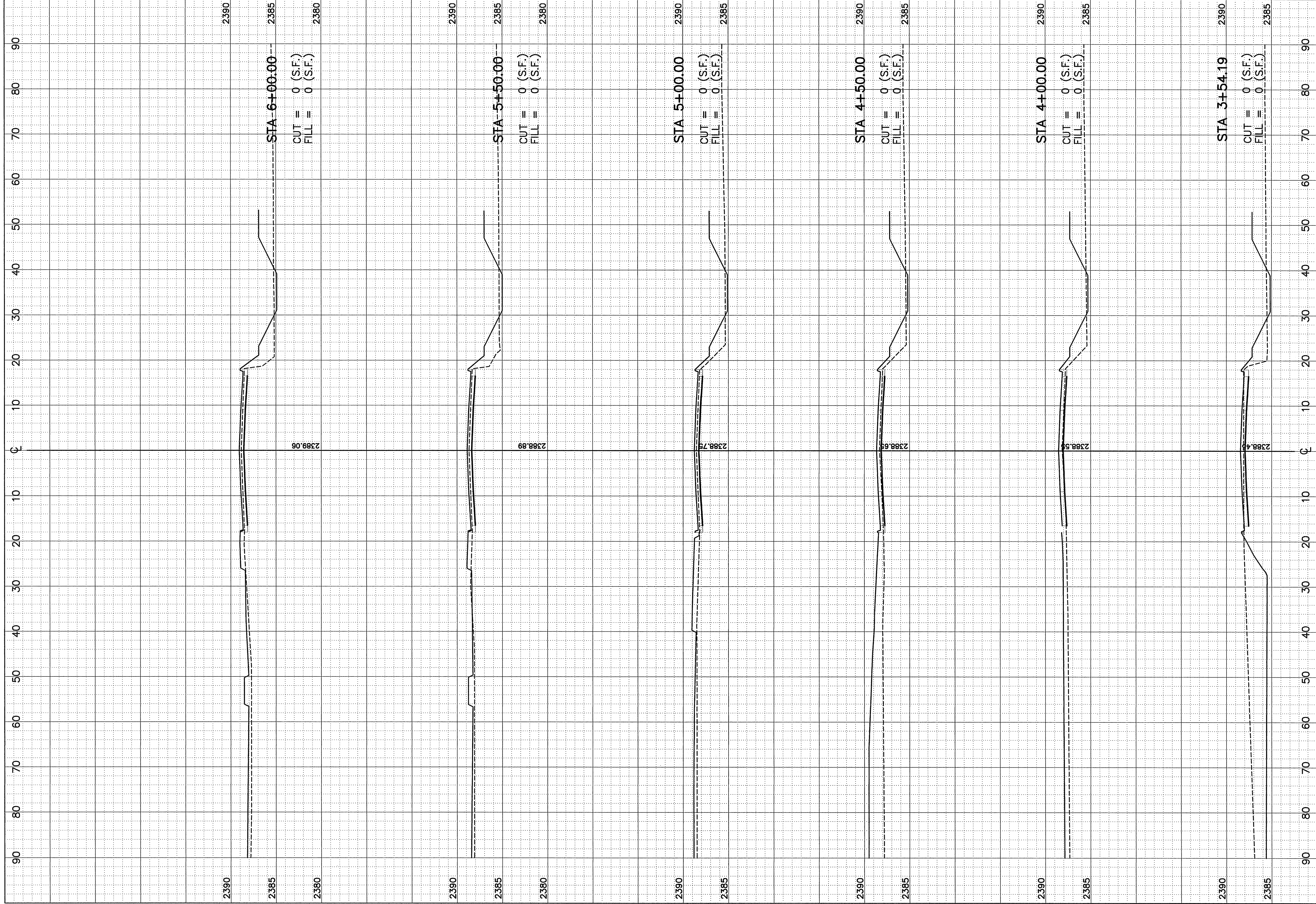

REVISIONS	BY



2015 OPPORTUNITY CENTER SOUTH PAVING IMPROVEMENTS
STREET A CROSS SECTIONS
 LEXINGTON, NEBRASKA

This document, and the ideas and designs incorporated herein, as an instrument of professional service, is the property of Miller & Associates and is not to be used in whole or in part, for any other project without the written authorization of Miller & Associates.

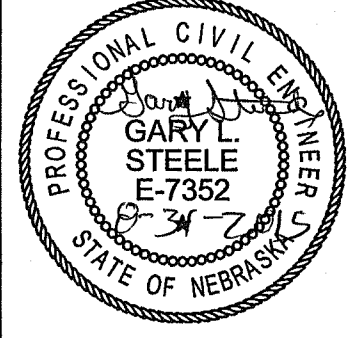

VERIFY SCALES	
BAR IS ONE INCH ON ORIGINAL DRAWING	
0" = 1"	
IF NOT ONE INCH ON THIS SHEET, ADJUST SCALES ACCORDINGLY.	
SCALE:	1"=5' VERT 1"=10' HORZ
PROJECT NO.	127-A1-101
DATE:	AUGUST, 2015
FIELD BOOK	M&A DWG NO. 30388
DRAWN BY:	LMA
APRVD BY:	
SHEET	

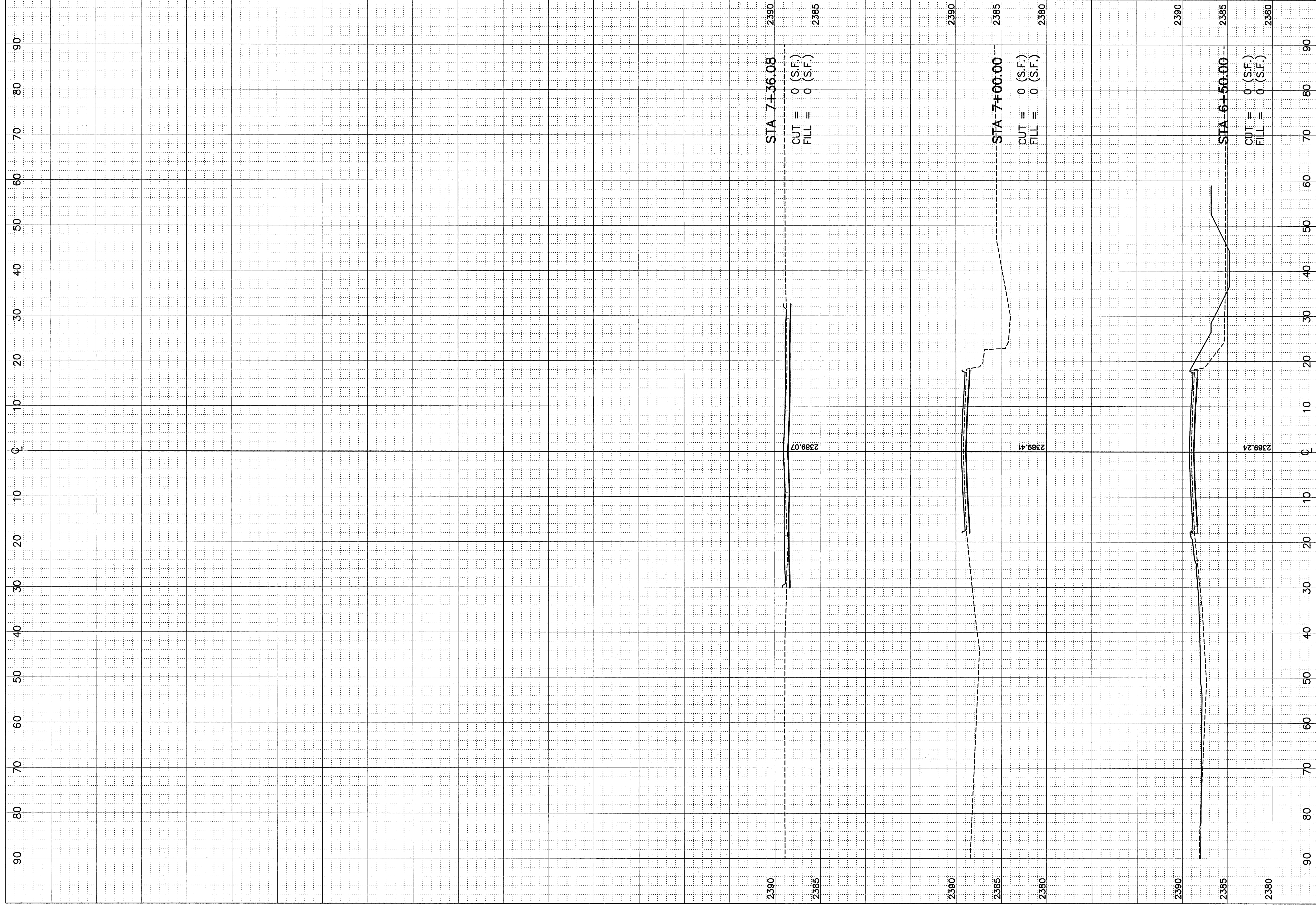

STA 7+36.08
 CUT = 0 (S.F.)
 FILL = 0 (S.F.)

STA 7+00.00
 CUT = 0 (S.F.)
 FILL = 0 (S.F.)

STA 6+50.00
 CUT = 0 (S.F.)
 FILL = 0 (S.F.)

REVISIONS	BY



2015 OPPORTUNITY CENTER PAVING IMPROVEMENTS
STREET A CROSS SECTIONS
 LEXINGTON, NEBRASKA

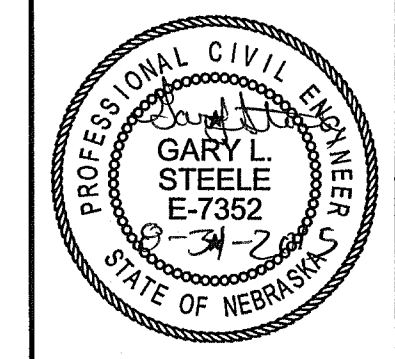

VERIFY SCALES	
BAR IS ONE INCH ON ORIGINAL DRAWING	
0" = 1"	
IF NOT ONE INCH ON THIS SHEET, ADJUST SCALES ACCORDINGLY.	
SCALE:	1"=5' VERT 1"=10' HORZ
PROJECT NO.	127-A1-101
DATE:	AUGUST, 2015
FIELD BOOK	M&A DWG NO. 30387
DRAWN BY:	APRVD BY:
LMA	
SHEET	X-3

This document, and the ideas and designs incorporated herein, as an instrument of professional service, is the property of Miller & Associates and is not to be used in whole or in part, for any other project without the written authorization of Miller & Associates.