

DRAWINGS FOR

2015 HIGHWAY 283 MEDIAN IMPROVEMENTS

NOTES:

1. CONTRACTOR IS TO COORDINATE ALL STREET CLOSINGS WITH THE CITY OF LEXINGTON. NOTIFY FIRE/RESCUE DEPARTMENT, AND ALL ADJOINING PROPERTY OWNERS 72 HOURS PRIOR TO CLOSING STREETS OR DRIVES, OR AS NOTED IN THE SPECIFICATIONS.
2. THE LOCATION OF ALL AERIAL AND UNDERGROUND UTILITY FACILITIES MAY NOT BE INDICATED IN THESE DRAWINGS. UNDERGROUND UTILITIES, WHETHER INDICATED OR NOT, WILL BE LOCATED AND FLAGGED BY THE UTILITIES AT THE REQUEST OF THE CONTRACTOR.
3. NO EXCAVATION WILL BE PERMITTED IN THE AREA OF UNDERGROUND UTILITY FACILITIES UNTIL ALL SUCH FACILITIES HAVE BEEN LOCATED AND IDENTIFIED TO THE SATISFACTION OF ALL PARTIES AND THEN ONLY WITH EXTREME CARE TO AVOID ANY POSSIBILITY OF DAMAGE TO THE UTILITY FACILITY.
4. ALL SIGNS, MAILBOXES, CULVERTS, GUYWIRES, FENCES, AND PROPERTY PINS ENCOUNTERED DURING THE CONTRACTOR'S OPERATIONS SHALL BE RESTORED TO ORIGINAL CONDITION AT THE CONTRACTOR'S EXPENSE.
5. THE QUANTITIES OF EACH ITEM LISTED ON THE BID SCHEDULE MAY VARY FROM THE TOTAL QUANTITIES. THE CITY MAY ADD OR DELETE FROM THE PROJECT, PORTIONS OF IMPROVEMENTS.
6. SAW CUTTING OF PAVEMENT IS REQUIRED FOR REMOVAL AND IS INCIDENTAL TO THE PROJECT. ADDITIONAL SAW CUTTING BEYOND THAT WHICH IS INDICATED ON THE DRAWINGS MAY BE REQUIRED.
7. TOPSOIL SHALL BE REMOVED, STOCKPILED AND REPLACED FOR ALL EXCAVATION AREAS.
8. CONTRACTOR SHALL GUARD AND PROTECT ALL TREES, SHRUBS, FENCES, AND OTHER ITEMS NOT SPECIFICALLY MARKED FOR REMOVAL.
9. THE CONTRACTOR MAY CLOSE THE ROAD TO ALL BUT LOCAL TRAFFIC SUBJECT TO THE CONDITIONS PRESCRIBED IN THE STANDARD SPECIFICATIONS.
10. THE CONTRACTOR SHALL FIND A SUITABLE LOCATION BEYOND THE LIMITS OF THE RIGHT-OF-WAY TO DISPOSE OF EXCESS MATERIAL.

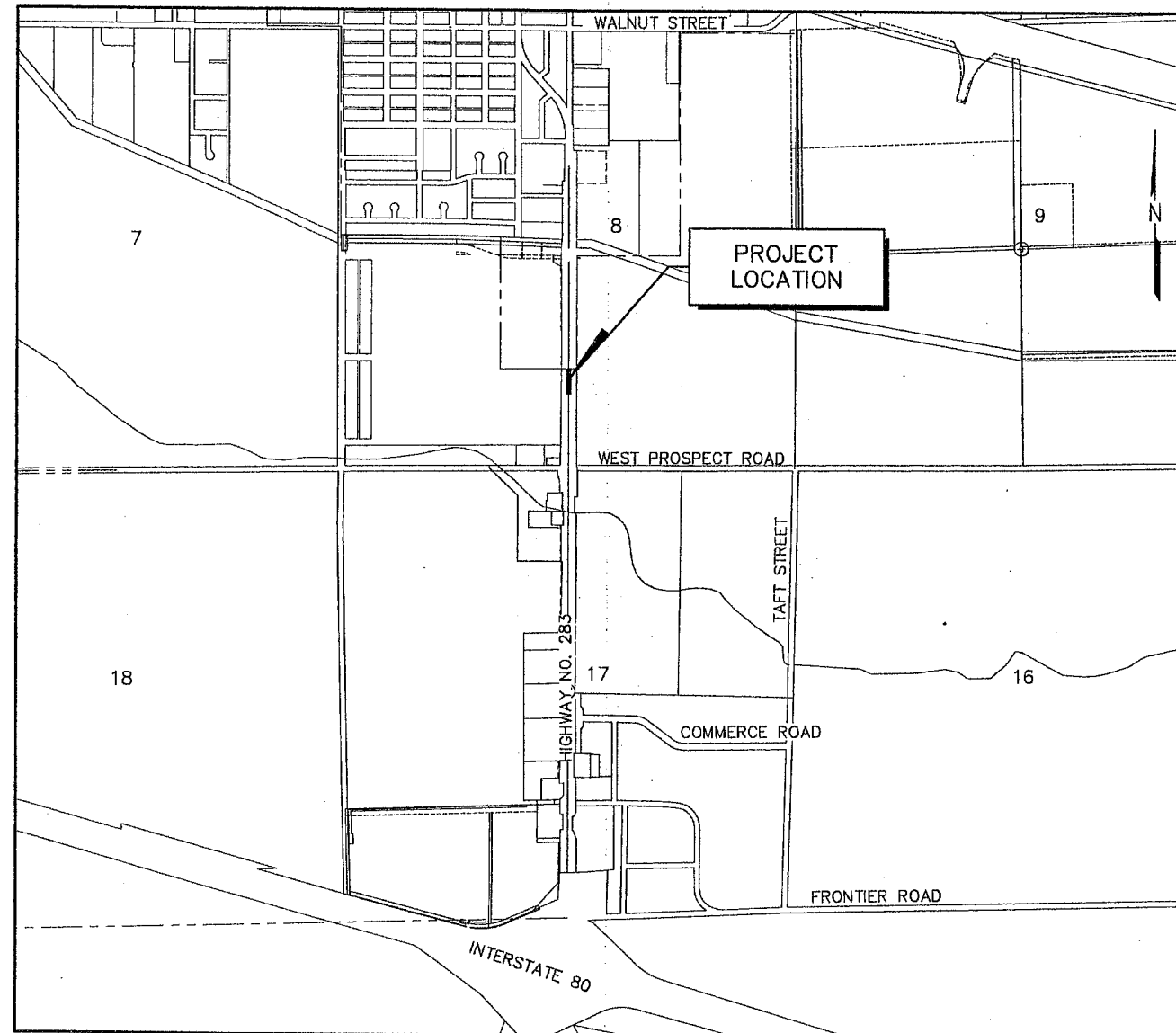

INDEX OF DRAWINGS	
SHT. NO.	DESCRIPTION
1	TITLE SHEET, LOCATION MAP & INDEX
2	NORTH BOUND HIGHWAY #283 SIGNAGE PLAN
3	SOUTH BOUND HIGHWAY #283 SIGNAGE PLAN
4	REMOVAL & CONSTRUCTION PLAN
5	PAVING DETAILS

LEXINGTON, NEBRASKA

M&A PROJECT NO. 127-A1-101

M&A MILLER & ASSOCIATES Consulting Engineers P.C.
1111 Central Avenue - Kearney, NE 68847

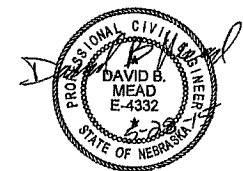

SET NO. 1
DRAWING NO. 29699

UTILITIES

GENERAL DIGGERS HOT LINE
8-1-1

2015 HIGHWAY #283 MEDIAN IMPROVEMENTS
NORTH BOUND HIGHWAY #283 SIGNAGE PLAN
 LEXINGTON, NEBRASKA

PROFESSIONAL CIVIL ENGINEER
 DAVID B. MEAD
 E-4332
 STATE OF NEBRASKA

VERIFY SCALES
 BAR IS ONE INCH ON ORIGINAL DRAWING
 IF NOT ONE INCH ON THIS SHEET, ADJUST SCALES ACCORDINGLY.
 SCALE: 1"=50'
 PROJECT NO. 127-A1-101
 DATE: MAY, 2015
 FIELD BOOK M&A DWG NO. 29998
 DRAWN BY: LMS
 APRVD BY: DPM
 SHEET 2

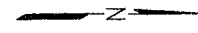

W20-1A-48
 2 EA. REQUIRED



W20-5LA-48
 2 EA. REQUIRED

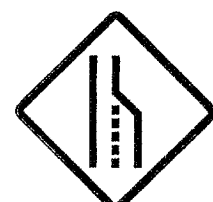

W4-2L-48
 2 EA. REQUIRED

MOUNT ALL SIGNS ON TYPE III BARRICADES 7 EA. REQUIRED

FLASHING ARROW PANEL

PROPOSED CONSTRUCTION OF LEFT TURN LANE

STATE HIGHWAY #283 (PLUM CREEK PARKWAY)

540' TAPER LENGTH
 DRUMS @ 45' SPACING
 13 EA. REQUIRED
 TAPER RATE = 45:1

270' LENGTH
 DRUMS @ 90' SPACING
 4 EA. REQUIRED

END ROAD WORK
 Thank You
 Drive Safely

G20-2B-48

NORTH BOUND INSIDE LANE CLOSURE

S:\Projects\127\127-A1-101\127-A1-101-C&D\127-A1-101-C&D-127-A1-101-C&D-127-A1-101-C&D.dwg
 PLOTTED: 5/28/2015 2:11 PM
 SAVED: 5/27/2015 11:55 AM

2015 HIGHWAY #283 MEDIAN IMPROVEMENTS
SOUTH BOUND HIGHWAY #283 SIGNAGE PLAN
 LEXINGTON, NEBRASKA

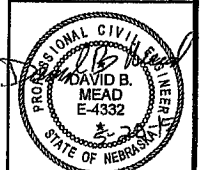

VERIFY SCALES
 BAR IS ONE INCH ON ORIGINAL DRAWING
 0 1"
 IF NOT ONE INCH ON THIS SHEET, ADJUST SCALES ACCORDINGLY.

SCALE: 1"=50'
 PROJECT NO. 127-A1-101
 DATE: MAY, 2015
 FIELD BOOK M&A DWG NO. 29997
 DRAWN BY: LMS APRVD BY: DDM
 SHEET 3

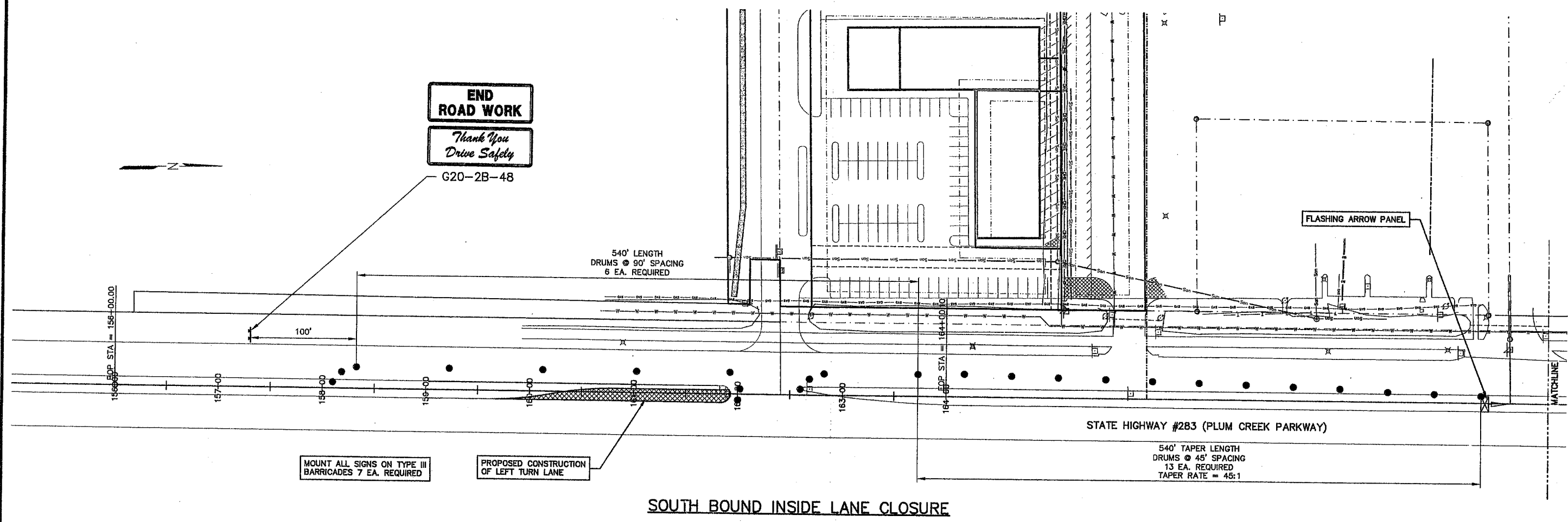

SOUTH BOUND INSIDE LANE CLOSURE

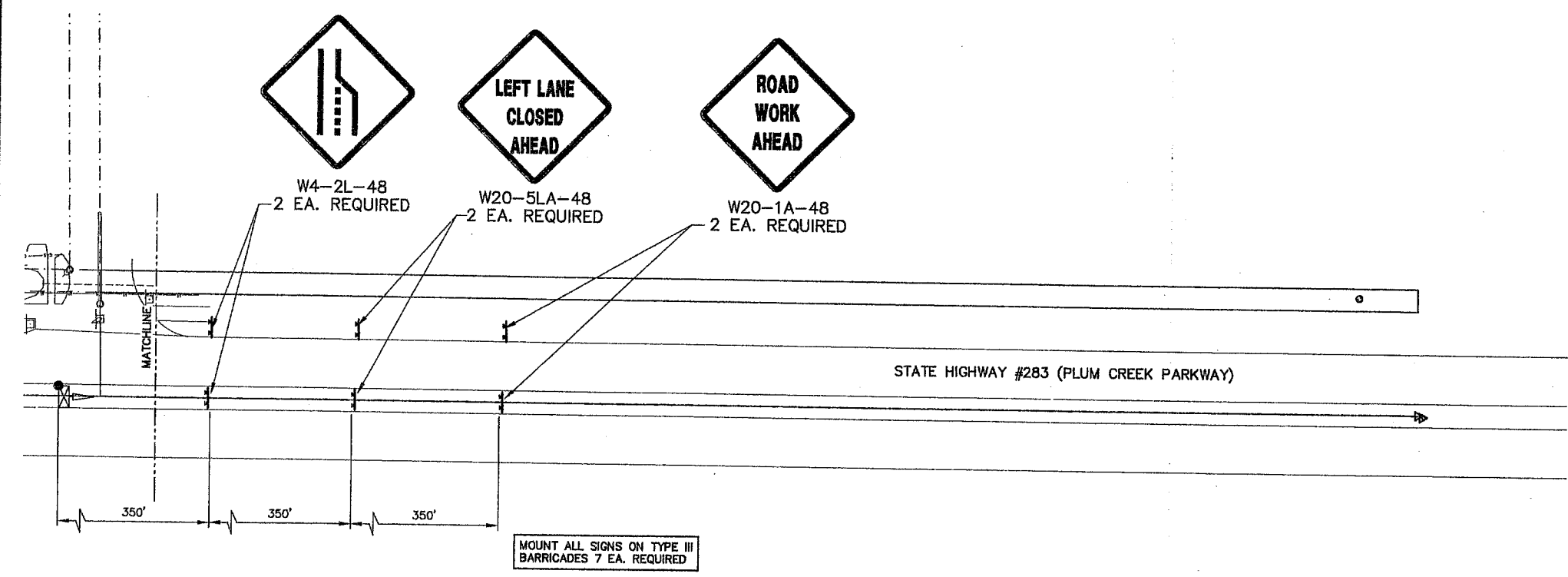

SOUTH BOUND INSIDE LANE CLOSURE

PLOTTED: 5/28/2015 2:12 PM
 C:\Projects\127\127-A1-101\Drawings\LEI\LEI283.dwg
 SAVER: 5/27/2015 11:05 AM

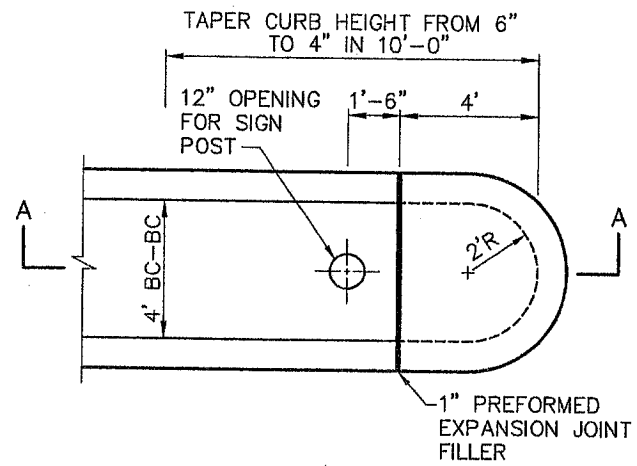

PLAN VIEW

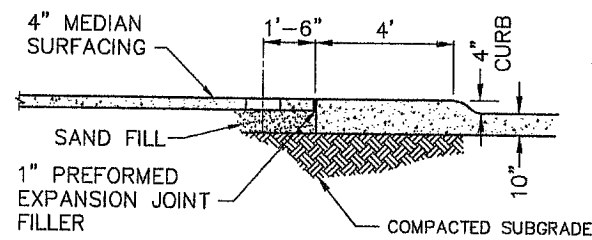

SECTION A-A

DETAIL AT END OF MEDIAN ISLAND
NO SCALE

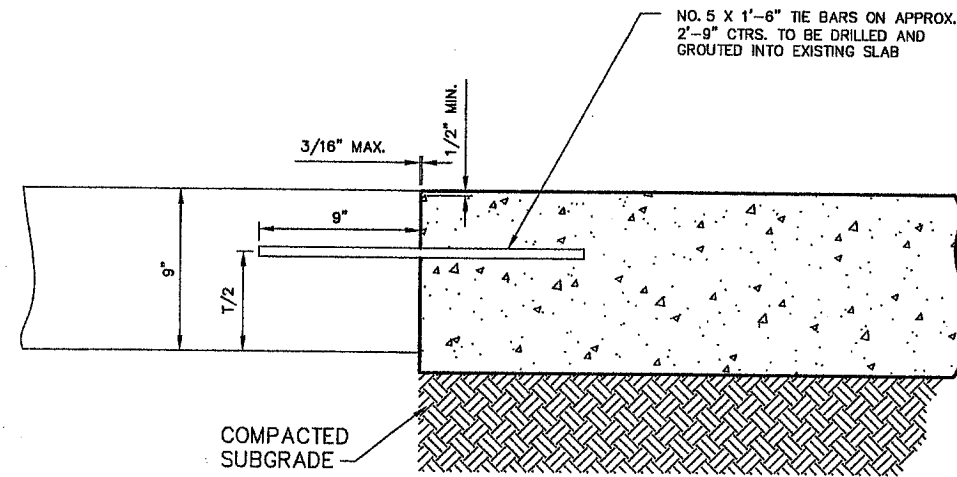

TIE BARS ARE TO BE INSTALLED WHERE NEW CONCRETE PAVEMENT IS PLACED ADJACENT TO EXISTING CONCRETE PAVEMENT

NO SCALE
TIE BAR DETAIL

CURB SECTION SHALL BE PLACED INTEGRAL WITH PAVEMENT SLAB

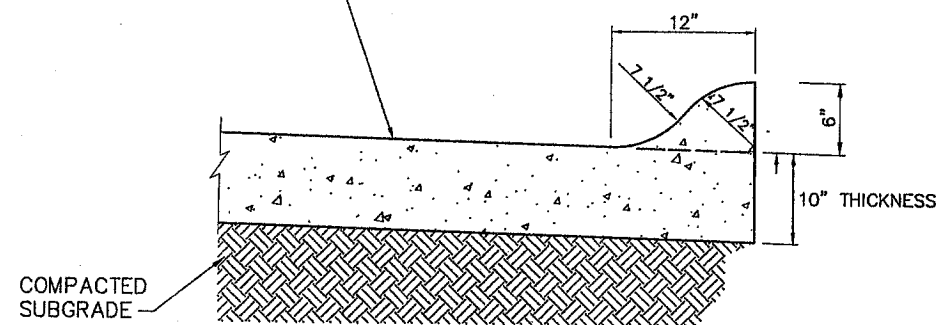

NOTE:
EXTREME CARE SHALL BE USED IN FINISH WORK TO ELIMINATE "LOW SPOTS" AND "POCKETS" WHEN CONSTRUCTING FLAT GRADES

STANDARD INTEGRAL CURB SECTION
NO SCALE

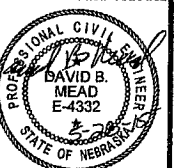

VERIFY SCALES
BAR IS ONE INCH ON ORIGINAL DRAWING
IF NOT ONE INCH ON THIS SHEET, ADJUST SCALES ACCORDINGLY.

SCALE: 1"=20'
PROJECT NO. 127-A1-101
DATE: MAY, 2015
FIELD BOOK M&A DWG NO. 28695
DRAWN BY: LMS
APR'D BY: DLM
SHEET 5