

**DEED OF DEDICATION**

DONA;D E. PRICE, a single person, Grantor, whether one or more, for valuable consideration, receipt of which is hereby acknowledged, hereby dedicates and conveys unto THE CITY OF LEXINGTON, NEBRASKA, Grantee, the following described real estate, to be used as a Public Street Right-of-Way, and for the use and benefit of the public:

A tract of land being part of Tract G of the Subdivision of the East One-Half of Section 6, Township 9 North, Range 21 West of the 6<sup>th</sup> P.M. , Dawson County, Nebraska, being more particularly described as follows:

Beginning at the Southwest Corner of Block 8 of C.L. Ervin’s Subdivision to the City of Lexington;  
Thence Southerly and along the East Line of said Tract G, to the Northwest Corner of Lot 6 of Tract G of the Subdivision of the East One-Half of Section 6, Township 9 North, Range 21 West;  
Thence Westerly to the Southeast Corner of Price’s 2<sup>nd</sup> Addition to the City of Lexington;  
Thence Northerly and along the East Line of Price’s 2<sup>nd</sup> Addition, to a point on the North Line of Maple Street extended westerly;  
Thence Easterly to the place of beginning.

Executed:     August \_\_\_\_, 2007.

\_\_\_\_\_  
Donald E. Price

STATE OF NEBRASKA,    )  
  ) ss.  
COUNTY OF DAWSON.    )

The foregoing instrument was acknowledged before me this \_\_\_\_ day of \_\_\_\_\_, 2007, by DON E. PRICE. As single person.

\_\_\_\_\_  
Notary Public

**RESOLUTION NO. 07-**

BE IT RESOLVED BY THE MAYOR AND COUNCIL OF THE CITY OF LEXINGTON, NEBRASKA, AS FOLLOWS:

That the Deed of Dedication to the City of Lexington, Dawson County, Nebraska, from DONALD E. PRICE, of the following described real estate, to be used as Street Right-of-Way for Maple Street, to-wit:

A tract of land being part of Tract G of the Subdivision of the East One-Half of Section 6, Township 9 North, Range 21 West of the 6<sup>th</sup> P.M. , Dawson County, Nebraska, being more particularly described as follows:  
Beginning at the Southwest Corner of Block 8 of C.L. Ervin's Subdivision to the City of Lexington;  
Thence Southerly and along the East Line of said Tract G, to the Northwest Corner of Lot 6 of Tract G of the Subdivision of the East One-Half of Section 6, Township 9 North, Range 21 West;  
Thence Westerly to the Southeast Corner of Price's 2<sup>nd</sup> Addition to the City of Lexington;  
Thence Northerly and along the East Line of Price's 2<sup>nd</sup> Addition, to a point on the North Line of Maple Street extended westerly;  
Thence Easterly to the place of beginning.

is approved, accepted and ordered filed and recorded in the office of the Register of Deeds of Dawson County, Nebraska, and hereafter the said real estate shall be a Public Street, subject to the ordinances, rules and regulations of the City.

PASSED AND APPROVED August \_\_\_\_, 2007.

CITY OF LEXINGTON, NEBRASKA

BY: \_\_\_\_\_  
Mayor

ATTEST:

\_\_\_\_\_  
City Clerk

Tracts of land in part of Tract G of the Subdivision of the East One-Half of Section 6, Township 9 North, Range 21 West of the 6th P.M., and within the City of Lexington, Dawson County, Nebraska

This Plat Approved under Administrative Ordinance No. 1816  
 By: *[Signature]* Date: 8-27-07

PRICE'S ADDITION

SPRUCE STREET

North Line of Tract G of the Subdivision of the East One-Half of Section 6-9-21.

(997.56'R)

SE COR (42.69'R) (37.31'R)

1 A tract of land being part of Tract G of the Subdivision of the East One-Half of Section 6, Township 9 North, Range 21 West of the 6th P.M., Dawson County Nebraska, being more particularly described as follows:

Beginning at the Southeast Corner of Price's Addition to the City of Lexington, Dawson County, Nebraska;

Thence Southerly along the East Line of Tract G of the Subdivision of the East One-Half of Section 6, Township 9 North, Range 21 West, and also the West Line of Block 8 of C. L. ERVIN'S SUBDIVISION to the City of Lexington, to the Southwest Corner of said Block 8;

Thence Westerly along the North Line of Maple Street extended Westerly, to a point on the East Line of Prices 2nd Addition to the City of Lexington, Dawson County, Nebraska;

Thence Northerly, along the East Line of said Price's 2nd Addition, to the Northeast Corner of said Price's 2nd Addition, said point lying on the South Line of Spruce Street;

Thence Easterly along said South Line of Spruce Street, to the place of beginning;

PRICE'S 2ND ADDITION

2 A tract of land being part of Tract G of the Subdivision of the East One-Half of Section 6, Township 9 North, Range 21 West of the 6th P.M., Dawson County Nebraska, being more particularly described as follows:

Beginning at the Southwest Corner of Block 8 of C. L. ERVIN'S SUBDIVISION to the City of Lexington;

Thence Southerly and along the East Line of said Tract G, to the Northwest Corner of, Lot 6 of the Subdivision of the East One-Half of Section 6, Township 9 North, Range 21 West;

Thence Westerly to the Southeast Corner of Price's 2nd Addition to the City of Lexington;

Thence Northerly and along the East Line of Price's 2nd Addition, to a point on the North Line of Maple Street extended westerly;

Thence Easterly, to the place of beginning.

3 A tract of land being part of Tract G of the Subdivision of the East One-Half of Section 6, Township 9 North, Range 21 West of the 6th P.M., Dawson County Nebraska, being more particularly described as follows:

Beginning at the Northwest Corner of Lot 6 of the Subdivision of the East One-Half of Section 6, Township 9 North, Range 21 West;

Thence Southerly and along the East Line of said Tract G, and also the West Line of said Lot 6, to the Northeast Corner of a tract of land previously surveyed by Gary Donnelson L.S. # 292 on October 29th, 1998;

Thence Westerly along the North Line of said surveyed tract, to the Northwest Corner of said surveyed tract;

Thence Northerly, to the Southeast Corner of Price's 2nd Addition to the City of Lexington, Dawson County, Nebraska;

Thence Easterly, to the place of beginning.

Information on this plat compiled from available and recorded data from the Office of the Dawson County Surveyor. I hereby certify that the information shown is true and correct to the best of my knowledge and belief.

*[Signature]*  
 GARY DONNELSON LS-292  
 Dawson County Surveyor

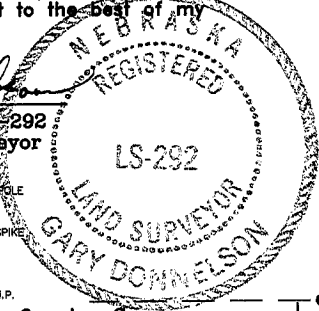

TRACT OF LAND SURVEYED BY:  
 GARY DONNELSON L.S. #292  
 DATED: OCT. 29, 1998.

0 75' 150'

0.00' Measured Distance.  
 (0.00'P) Platted Distance.  
 (0.00'R) Recorded Distance.

• Angle Point.  
 ● Corner Set(5/8" Rebar).  
 ○ Corner Found(Iron).  
 △ Gov't. Corner.

Ref.: Lexington F.B. 33-X, page 53-55.

Ref.: Lexington F.B. 33-Y, at page 20.

Recorded in Lexington F.B. 34-A, at page 55.

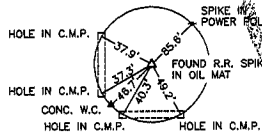

South One-Quarter Corner Section 6-9-21.

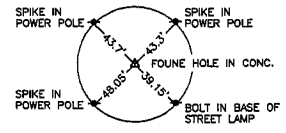

Southeast Corner Section 6-9-21.

(2641.71'R)

South Line of the Southeast Quarter.

East Line of Tract G of the Subdivision of the East One-Half of Section 6-9-21.

County Road R.O.W. Line.

WEST - (716.20'R)

(479.49'R)

G

60'

SE COR

TRACT

2

MAPLE STREET

80'

(737.33'R)

3

(165.47'R)

(357.49'R)

(258.00'R)

(258.00'R)

(165.48'R)

(165.48'R)

BLOCK 8

C.L. ERVIN'S SUB.

LOT 6 OF THE SUBDIVISION OF THE E 1/2 OF SEC. 6-9-21.