

# Lexington East Viaduct

Dawson County, NE

RRZ-TMT-1705(3), CN 61457

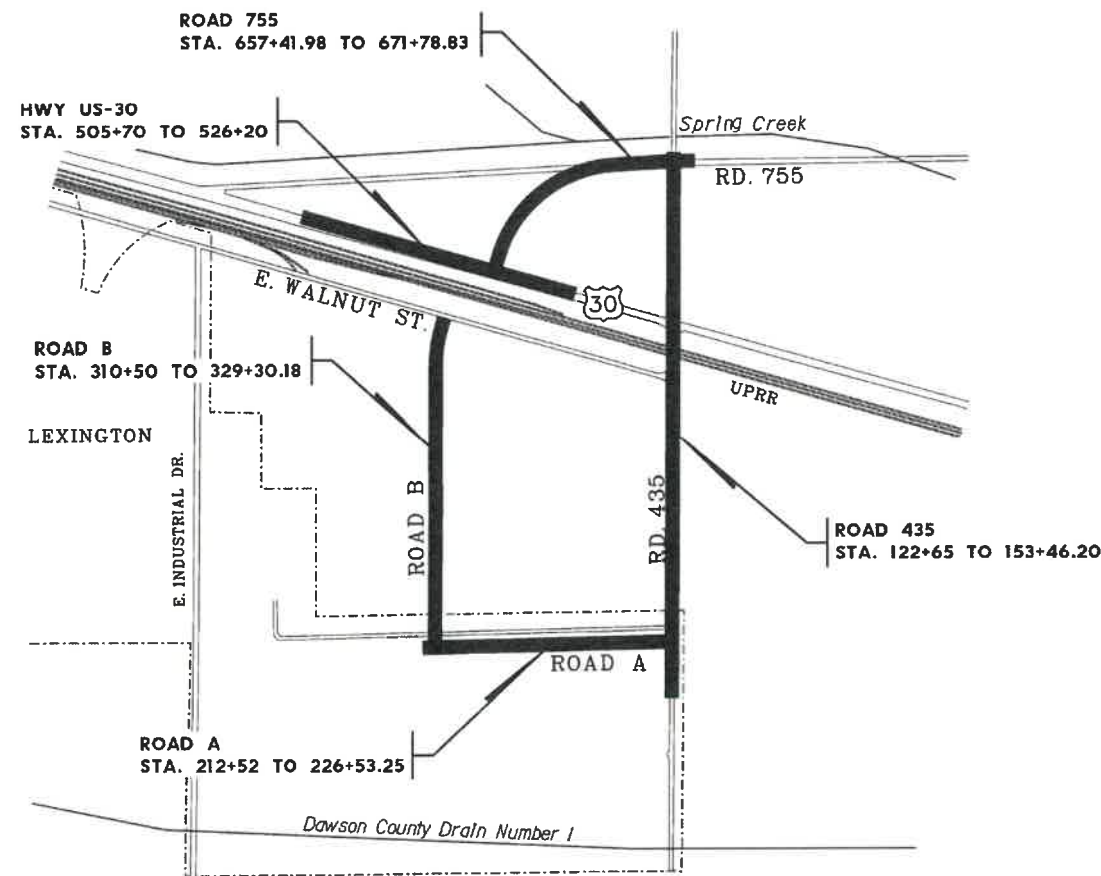

# Roadway Improvement Information

## Lexington East Viaduct

**Phase 1-** Scheduled to begin April 1, 2024. Work to be completed in this phase includes storm sewer, grading, and paving of Road A and Road B. During this first phase of construction only Road A and B will be closed to traffic, and access to businesses and thru traffic will remain along Road 435 and Walnut Street. New private driveways will be constructed along Hwy 30 Road 755 to provide access to businesses and residents during future phases. Construction is anticipated to last approximately 35 days.

**Phase 2-** This phase will be constructed in three parts, A, B, and C to ensure access to businesses can be maintained. Work will begin for Phase 2A along the south portion of Road 435 starting approximately 300 feet south of Road A and extending approximately 200 feet north of Road A. Construction will consist of removing the existing pavement, installing storm sewer, grading, and constructing the new pavement. Work on Phase 2A will require closure of the intersection of Road 435 and Road A and is expected to start late April. During this closure local traffic only will be allowed on Road 435, and all thru traffic will be detoured. Once 2A is complete, the intersection will be opened to traffic, and work will progress into Phases 2B and 2C with continued closure of Road 435 for thru traffic. Roads A and B will be open to traffic before work begins on Phase 2B and 2C. All work in Phase 2 is expected to be complete by mid June.

**Phase 3-** Towards the end of but concurrent with Phase 2, work will begin along Highway 30. This work will include removal of the shoulder, grading,

and widening of the paving to allow for a future turn lane. Highway 30 will remain open to thru traffic during this time. This work will begin early June and should be completed toward the end of the month.

**Phase 4-** This work will likely overlap with Phase 3, and consists of removal and closure of Road 755. Work will include grading, storm sewer and paving. Work will begin mid June and will last until mid July. Towards the end of this phase, the intersection of Road 435/755 will be closed down and reconstructed. New accesses to the residences and businesses off of Hwy 30 and Road 755 will have already been constructed. Road 755 will be permanently closed during this phase and the intersection of Road 435/755 will be temporarily closed. During this closure, traffic will be detoured away from this intersection.

**Phase 5-** Work on Phase 5 is expected to begin towards the end of July 2024 and will last until October 2025. During this phase work will be completed along Road 435 from approximately 600' north of Road A up to Road 755. Work includes pavement removal, storm sewer, grading, bridge construction, roadway lighting and paving. During this closure businesses will obtain access from the newly constructed portions of Road 435 or from Walnut Street. Road 435 will be closed and thru traffic will be detoured along Roads 754 and 756 west to Highway 283 and Taft Street. There will also be intermittent interruptions along Highway 30 during this time and traffic will be detoured accordingly.

**City of Lexington**  
406 East 7<sup>th</sup> St.  
Lexington, NE 68805  
(308) 324-2341

**City Manager**  
Joe Pepplitsch

**Assistant City Manager**  
Dennis Burnside

**Construction Engineer**  
Olsson  
201 E. 2<sup>nd</sup> Street  
Grand Island, NE 68801  
(308)384-8750

**Project Manager**  
Steve Hancock

**Project Inspector**  
Aaron Van Luchene

**Prime Contractor**  
United Contractors Inc.  
6678 NW 62<sup>nd</sup> Avenue  
Johnston, Iowa 50131  
(515)577-2350

**Contractor's Project Supt.**  
Chuck Kadlecek

