

B_00 - SITE PLAN - EXTENT OF PAVING
1" = 30'-0"

- 4 INCH THICK WALKING TRACK - 18,250 SF
- 6 INCH THICK PARKING LOT - 29,700 SF
- 4 INCH THICK SIDEWALK - 20,900 SF
- 6 INCH THICK STREET PAVING - 24,200 SF
- 6 INCH THICK PARKING LOT - 24,650 SF



LEXINGTON PUBLIC SCHOOLS LEXINGTON
MIDDLE SCHOOL/ COMMUNITY RECREATION
FACILITY ADDITION
L12022
05-25-2012

BAHR VERMEER HAECKER ARCHITECTS
440 N 8TH ST STE 100
LINCOLN NE 68508
V 402 475 4551
F 402 475 0226
bvh.com



© COPYRIGHT BVH ARCHITECTS

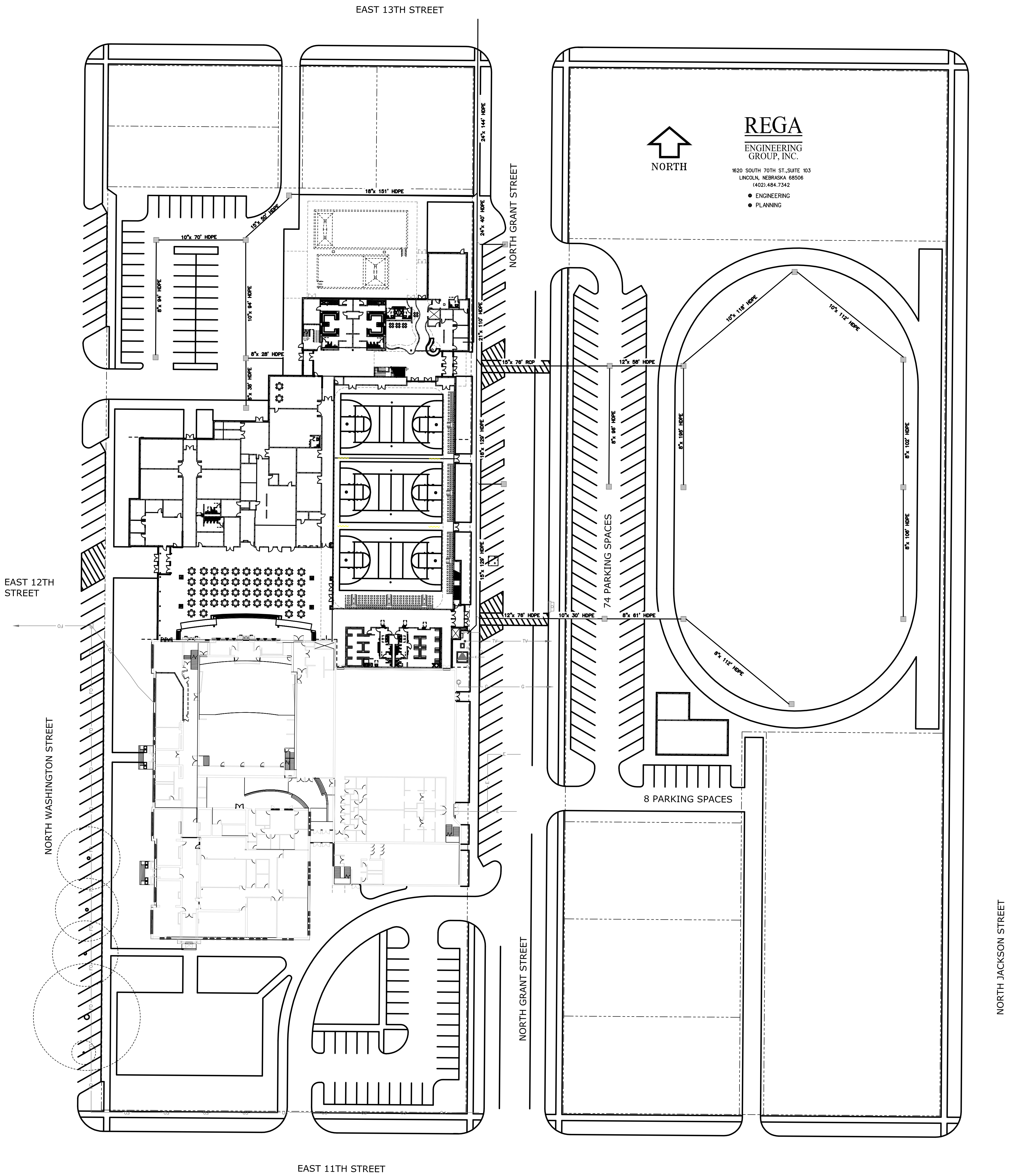

REGA
ENGINEERING
GROUP, INC.

1620 SOUTH 70TH ST., SUITE 103
LINCOLN, NEBRASKA 68506
(402) 484.7342

- ENGINEERING
- PLANNING



NORTH

8 PARKING SPACES

74 PARKING SPACES

EAST 13TH STREET

EAST 12TH STREET

EAST 11TH STREET

NORTH WASHINGTON STREET

NORTH GRANT STREET

NORTH GRANT STREET

NORTH JACKSON STREET